

COLUMBIA BASIN PROJECT - IRRIGATION BLOCK 43

GRANT COUNTY, WASHINGTON
and
ADAMS COUNTY, WASHINGTON

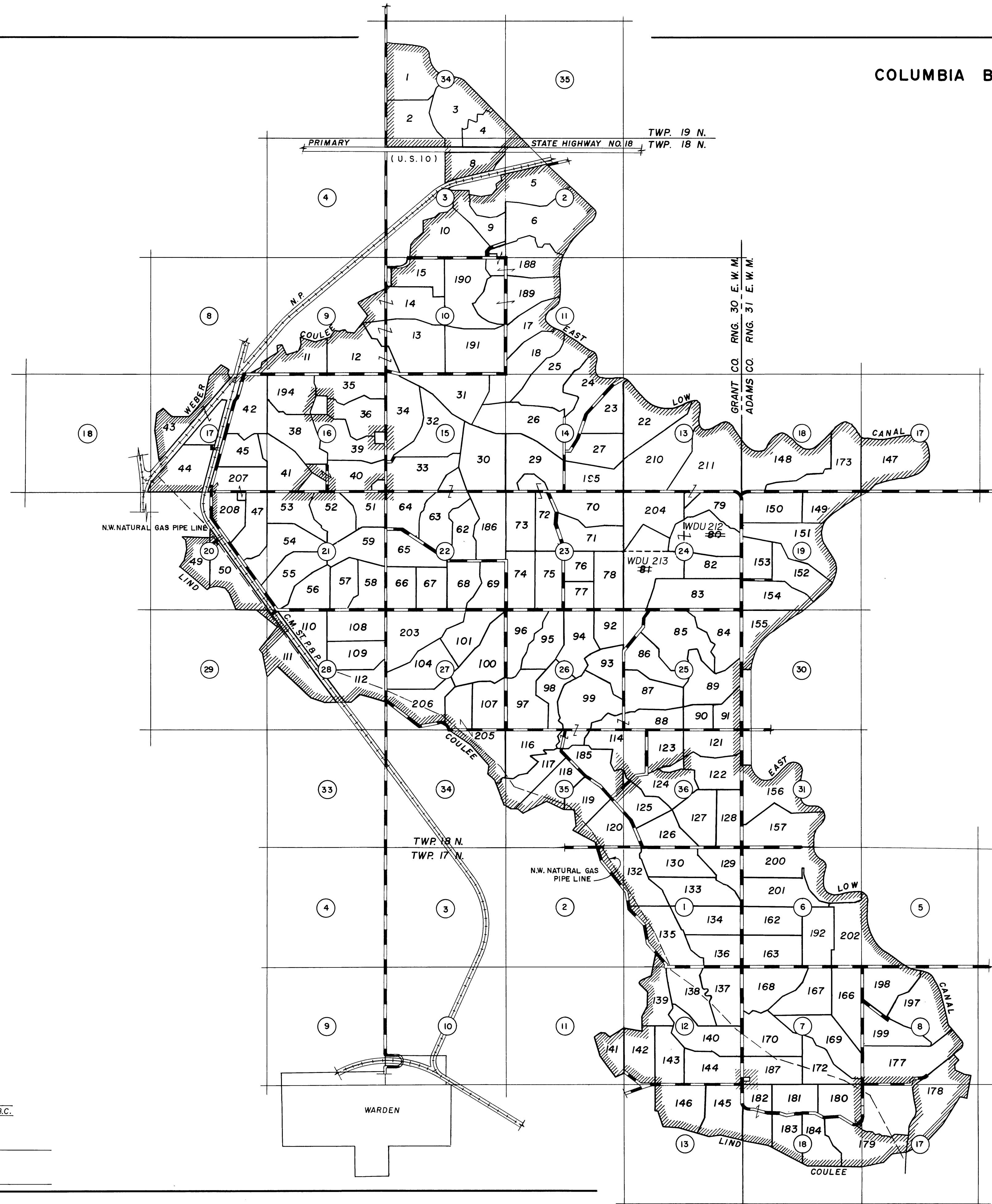

LEGEND

- BOUNDARY OF PLAT
- UNIT BOUNDARY
- ROAD THROUGH UNIT
- ROAD
- SECTION NUMBER
- UNIT NUMBER
- SECTION LINE
- Former Unit Boundary
- Northwest Natural gas pipeline

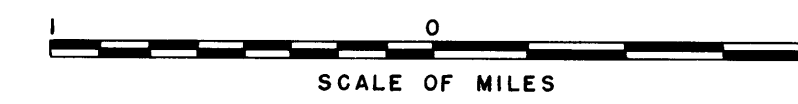

| | |
|-----------------|--------------------|
| REV. TO 12-8-64 | <i>[Signature]</i> |
| REV. TO 10-1-63 | <i>[Signature]</i> |

I certify that this is Sheet
1 of 2 General Map Sheets of
the Seventh Revision of the
Final Farm Unit Plat for
Irrigation Block 43 showing
the farm unit boundaries and
a tabulation of the acreages
by land classes in each farm
unit.

Merrill J. Martz
Regional Director (Act.)
DATE 9-18-59

Drawn H.E.M. A.R.S.
Checked A.R.S. A.B.C.

J. D. Humes
Chief, Engr. Div.
D.F.C. Div.

DATE 9-10-59