

Millerton Lake State Recreation Area
South Finegold Non-motorized Boating Access Ramp

South-Central California Area Office

Date: April 26, 2010

To:	Wildlife Biologist	SCC 424	<u>[Signature]</u>	S McDonald	<u>4/28/11</u>
	Supervisory Nat. Res. Specialist	SCC 411	<u>[Signature]</u>	C Siek	<u>4/28/11</u>
	Secretary	SCC 101		P Escobar	
	Chief, Resource Division	SCC 400	<u>[Signature]</u>	R English	<u>4/28/11</u>
	Deputy Area Manager	SCC 102	<u>[Signature]</u>	L Myers	<u>4/28/11</u>
	Natural Resource Specialist	SCC 413	<u>[Signature]</u>	R Healer	<u>4/28/11</u>

Cost Authority Number: **A20-1785-4997-000-00-0-0**

From: Rain Healer

Subject: Review and signing of Categorical Exclusion Checklist

Please review the attached CEC and route it according to the order on the list. When your review is finished, please date, initial and sign on the last page. However, if you have comments or questions please contact the Environmental Team or the proponent of the action. When everyone has signed the CEC, please return it to Rain Healer.

Thank you.

Ready for Central Files

4/28/11

Copies to: MP-3730 (1 Copy)
Natural Resources Specialist (1 Copy): Rain Healer – SCC-413
Project Lead (1 Copy): Jack Collins– SCC-452

CATEGORICAL EXCLUSION CHECKLIST
Millerton Lake State Recreation Area
South Finegold Non-motorized Boat Access Ramp

South-Central California Area Office

October 20, 2010

Background: Millerton Lake State Recreation Area (MLSRA) is located near Friant, California, 20 miles northeast of Fresno (Figure 1). The California Department of Parks and Recreation (CDPR) operate the MLSRA under an operating agreement with the Bureau of Reclamation (Reclamation). South Finegold is a day use area within the MLSRA consisting of picnic tables, barbecues, restrooms, and a small parking lot (Figure 2). Non-motorized boaters often use this area but are required to hike down to the water through a steep area since there isn't a boat launch at this site. California Department of Boating and Waterways has proposed installing a non-motorized boat ramp to provide better access at this site for non-motorized boaters (Figure 3).

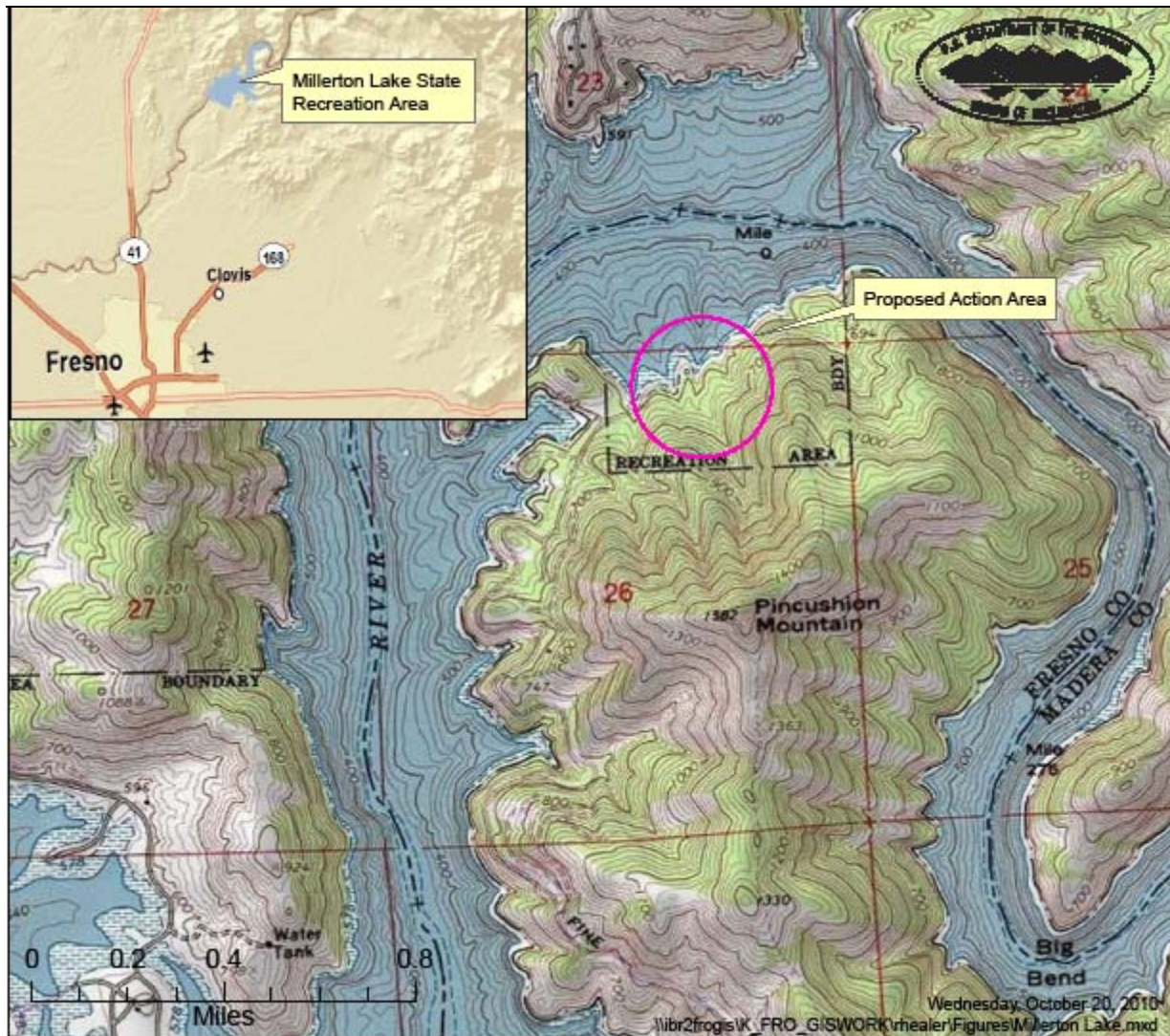

Figure 1. Proposed Action Location



Figure 2. Existing Day Use Area



Figure 3. Proposed location for new boat ramp at South Finegold

Purpose and Need for Action: The purpose of the Proposed Action is to provide an easier path for launching non-motorized boats from the existing parking area. The Proposed Action is needed in order to provide safer access for non-motorized boaters.

Proposed Action: CDPR proposes, on behalf of Reclamation, to have the California Department of Boating and Waterways install a non-motorized boat ramp within the South Finegold day use area with associated upgrades (see attached preliminary designs). The Proposed Action is located within the northeast quarter of Section 26, Township 10 South, Range 21 East, MDB&M (see Figure 1). Upgrades would consist of:

- Installation of a 20-feet wide by 200-feet long non-motorized concrete boat ramp with boarding float
- Installation of a concrete walk with hand rails from the loading zone to the boat ramp
- Installation of approximately 130 linear feet rip rap for shoreline stabilization
- Repaving and delineation of American with Disabilities Act (ADA) compliant parking stalls in the existing parking area
- Relocation of some ADA signage
- Demolition and replacement of some curbs and walkways near the loading zone
- Installation of new concrete wheel stops
- Installation of new concrete truncated domes for accessibility
- Trimming of two oak trees

Approximate amount of material needed for the Proposed Action would be:

Action Components	Concrete	Base Rock	Rip Rap	Asphalt
Boat Ramp	74 CY (6 inch)	74 CY (6 inch)	104 CY	--
Shoreline Protection	--	--	200 CY	--
Sidewalk	23 CY (4 inch)	34 CY (6 inch)	--	--
ADA Parking stalls	--	12 CY (6 inch)	--	641 square feet (2 inch)
Total	97 CY	120 CY	304 CY	641 square feet

CDPR is in the process of preparing an environmental document as required by the California Environmental Quality Act and will be applying for the necessary 404 and 401 permits. Copies of all permits would be provided to Reclamation. The Proposed Action would not begin unless all applicable permit/certification are obtained and would require that the Project Proponent adheres to the terms and conditions of said permit/certification.

Construction equipment would include: a bulldozer, dump truck, concrete truck, and backhoe. Construction would begin in early September 2011 and is expected to last approximately 90 days. Staging would occur within the existing parking area.

Exclusion Category: 516 DM 14.5C (3). Minor construction activities associated with authorized projects which correct unsatisfactory environmental conditions or which merely augment or supplement, or are enclosed within existing facilities.



STATE OF CALIFORNIA
THE RESOURCES AGENCY
DEPARTMENT OF BOATING AND WATERWAYS
BOATING FACILITIES DIVISION



PROJECT: SOUTH FINEGOLD NON MOTORIZED BOATING ACCESS
LOCATION: LAKE MILLERTON, FRESNO COUNTY
FILE NO. 804

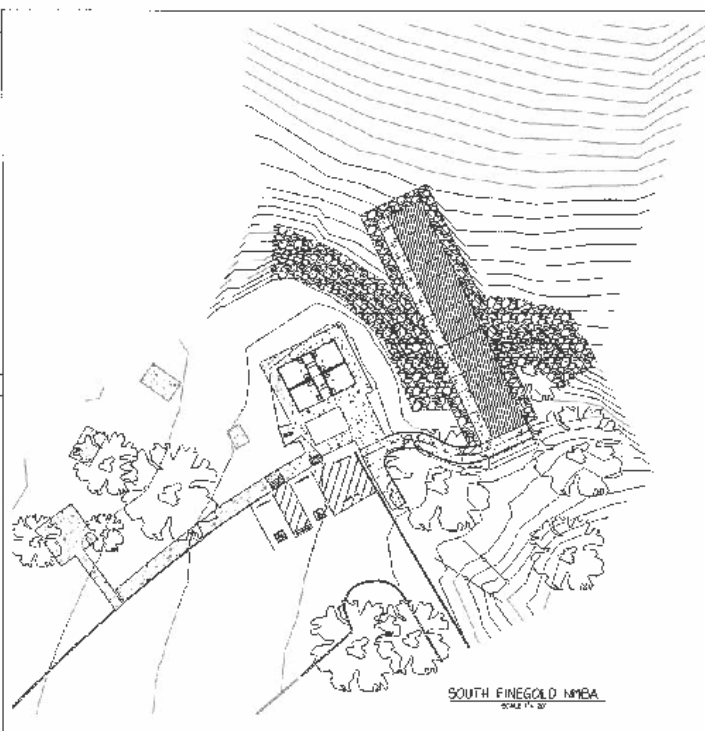
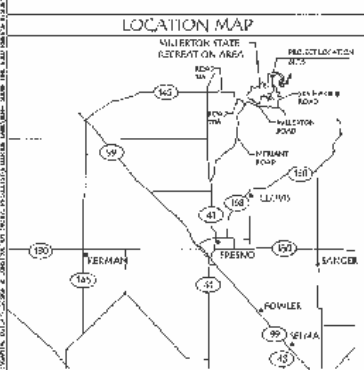

SHEET INDEX	
NO.	DESCRIPTION
1	TITLE SHEET
2	EXISTING CONDITIONS & PROPOSED IMPROVEMENTS
3	WATERWAY CONTROL & SITE PLAN
4	PLAN & PROFILE
5	DETAILS

PROJECT INFORMATION	
FUNDED BY STATE OF CALIFORNIA DEPARTMENT OF BOATING AND WATERWAYS DIVISION OF BOATING FACILITIES PROJECT NUMBER 804	FACILITY MAINTENANCE DIVISION OF BOATING FACILITIES DEPARTMENT OF BOATING AND WATERWAYS PROJECT NUMBER 804
SCOPE IMPROVEMENTS TO THE BOAT RAMP AND PARKING AREA AT THE SOUTH FINEGOLD NON-MOTORIZED BOATING ACCESS.	

SURVEY NOTE:	
ALL DIMENSIONS ARE IN FEET AND INCHES. DIMENSIONS ARE GIVEN TO THE CENTERLINE OF THE ROAD OR WATERWAY. DIMENSIONS ARE GIVEN TO THE CENTERLINE OF THE ROAD OR WATERWAY. DIMENSIONS ARE GIVEN TO THE CENTERLINE OF THE ROAD OR WATERWAY.	

CODE INFORMATION	
1. ALL DIMENSIONS ARE IN FEET AND INCHES. DIMENSIONS ARE GIVEN TO THE CENTERLINE OF THE ROAD OR WATERWAY. DIMENSIONS ARE GIVEN TO THE CENTERLINE OF THE ROAD OR WATERWAY. DIMENSIONS ARE GIVEN TO THE CENTERLINE OF THE ROAD OR WATERWAY.	2. ALL DIMENSIONS ARE IN FEET AND INCHES. DIMENSIONS ARE GIVEN TO THE CENTERLINE OF THE ROAD OR WATERWAY. DIMENSIONS ARE GIVEN TO THE CENTERLINE OF THE ROAD OR WATERWAY. DIMENSIONS ARE GIVEN TO THE CENTERLINE OF THE ROAD OR WATERWAY.



Division of Boating Facilities
Department of Boating and Waterways
Project No. 804
Date: 1/1/00
Scale: 1" = 100'

Project Name
SOUTH FINEGOLD NMBA
Location
MILLERTON LAKE AREA
FRESNO COUNTY

Project No. 804
Date: 1/1/00
Scale: 1" = 100'

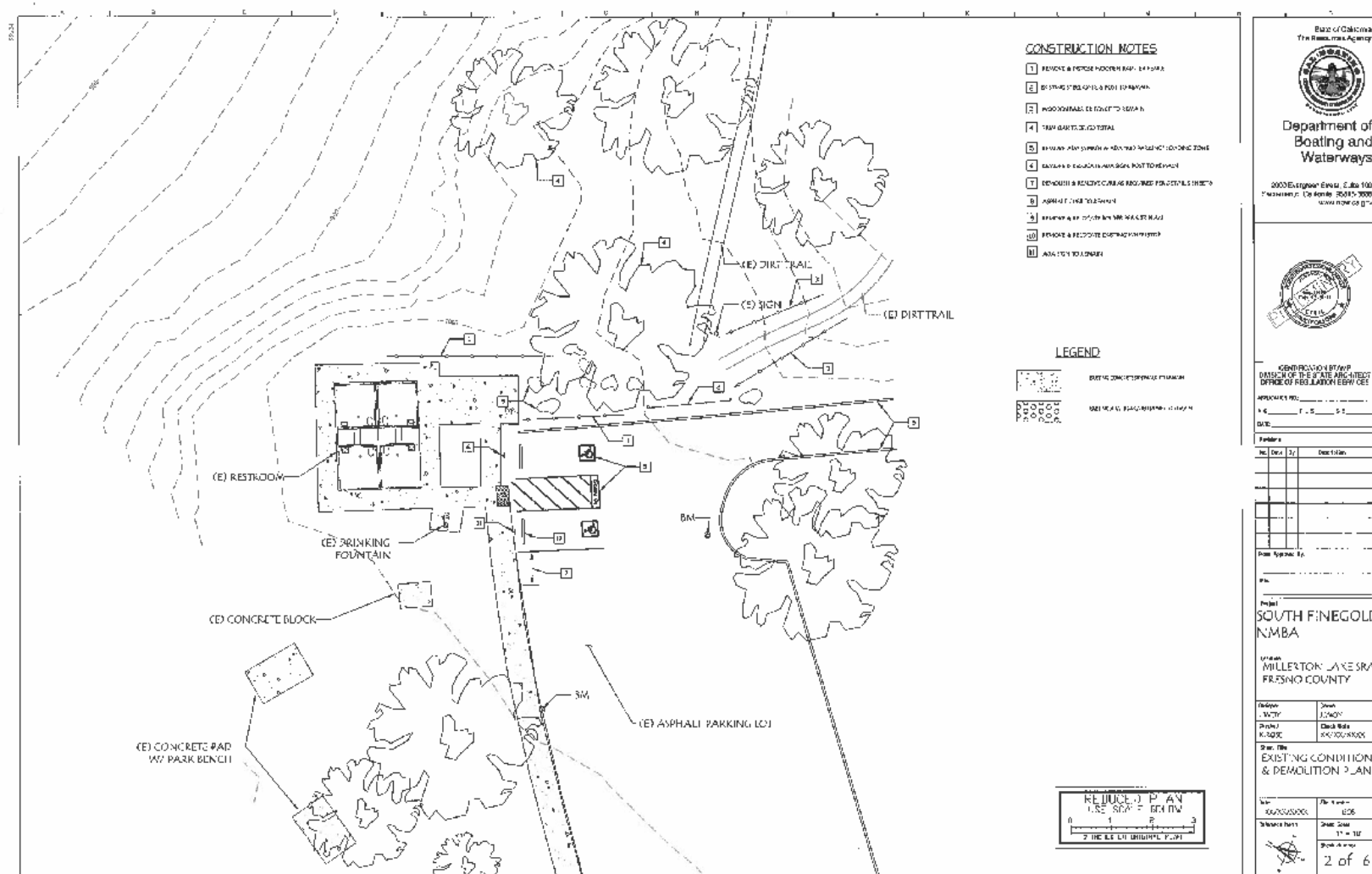

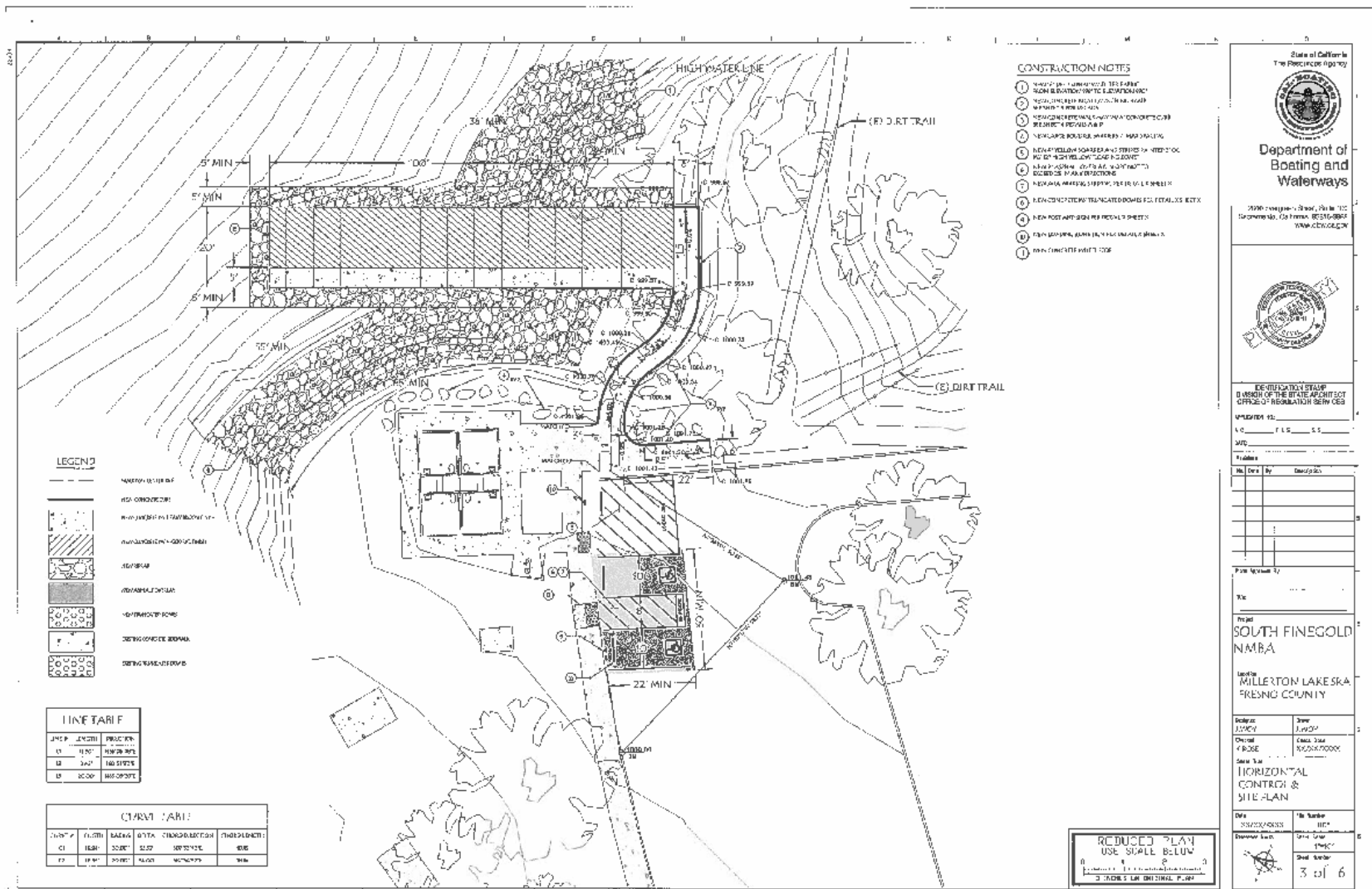

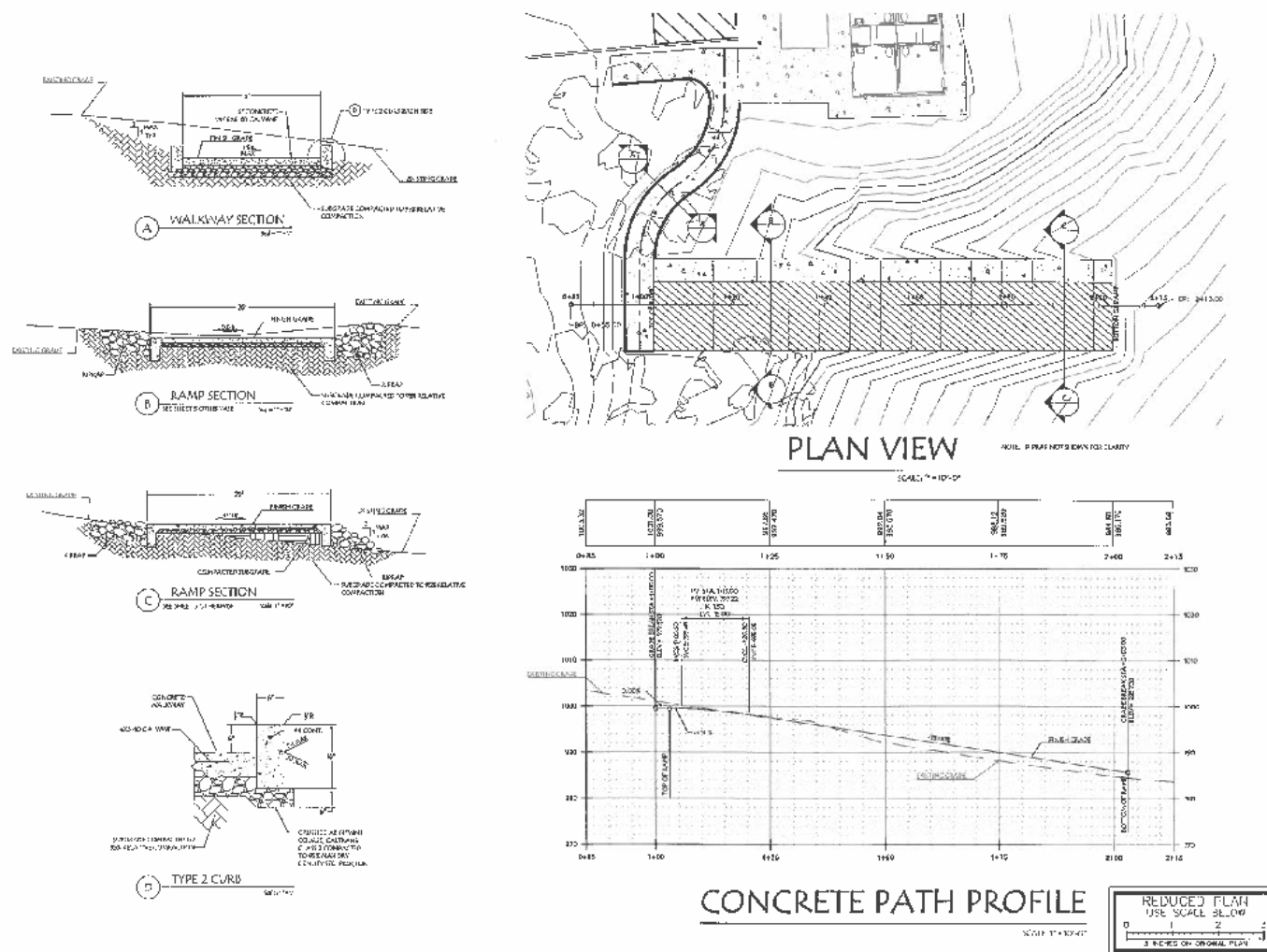

State of California
The Fisheries Agency
Department of Boating and Waterways

2000 Richardson Blvd., Suite 100
Sacramento, California 95811-3888
www.dbo.ca.gov



STATE OF CALIFORNIA
DIVISION OF THE STATE HIGHWAY
OFFICE OF REGULATION SERVICES

APP. NO. 1000-100
P. 1 - 5
DATE

Project

No. Date 1/21 Description

Project Approved by

Date

Project

SOUTH FINEGOLD

NMBA

Location

MILLERTON LAKE SRA

FRESNO COUNTY

Design

Drawn

Check

Scale

PLAN & PROFILE

Sheet

Sheet

Sheet

4 of 6

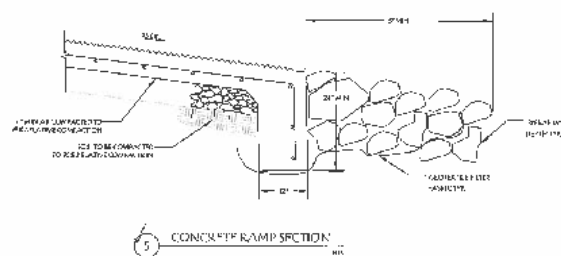
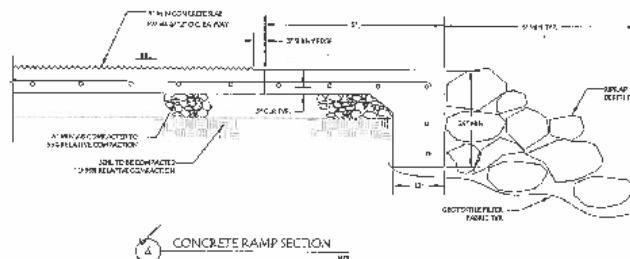
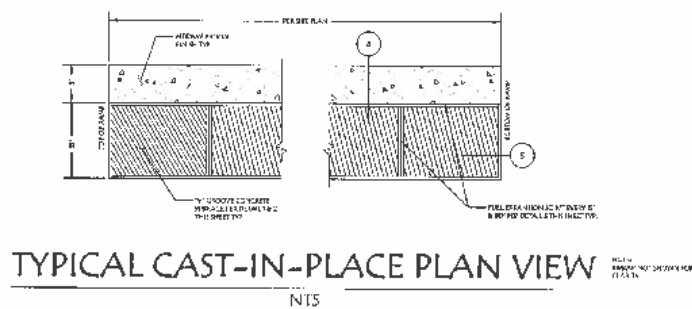

NOTES:
1. THIS DRAWING IS A GUIDE ONLY. THE USER SHALL BE RESPONSIBLE FOR THE DESIGN OF THE JOINT, INCLUDING THE CONSTRUCTION OF THE JOINT AND THE PROTECTION OF THE JOINT.

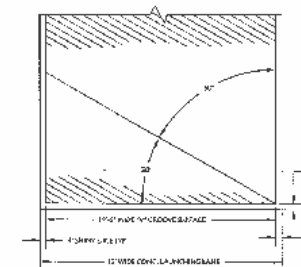

1. 1/2\"/>

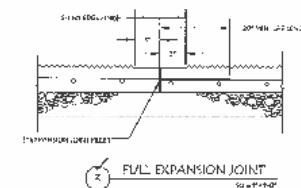
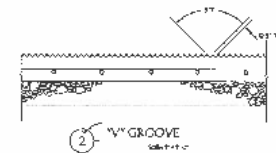

State of California
The Public Works Agency



Department of
Boating and
Waterways

2000 Engineering Station, Suite 100
Sacramento, California 95815-3833
www.dbo.ca.gov



IDENTIFICATION STAMP
ON THE STATE OF CALIFORNIA
OFFICE OF REGULATION SERVICES

DATE: 10/11/11

PROJECT: 100-100-100-100

LOCATION: 100-100-100-100

REVISIONS:

DATE: 10/11/11

BY: 100-100-100-100

FOR: 100-100-100-100

100-100-100-100

100-100-100-100

100-100-100-100

100-100-100-100

100-100-100-100

100-100-100-100

100-100-100-100

100-100-100-100

100-100-100-100

100-100-100-100

100-100-100-100

100-100-100-100

100-100-100-100

100-100-100-100

100-100-100-100

100-100-100-100

100-100-100-100

100-100-100-100

100-100-100-100

100-100-100-100

100-100-100-100

100-100-100-100

100-100-100-100

100-100-100-100

100-100-100-100

100-100-100-100

100-100-100-100

100-100-100-100

100-100-100-100

100-100-100-100

100-100-100-100

100-100-100-100

100-100-100-100

100-100-100-100

100-100-100-100

100-100-100-100

100-100-100-100

100-100-100-100

100-100-100-100

100-100-100-100

100-100-100-100

100-100-100-100

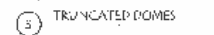
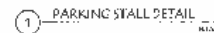
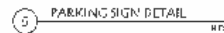
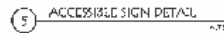
9

Evaluation of Criteria for Categorical Exclusion

- | | | | |
|--|-----------------|-------------------------|-----|
| 1. This action would have a significant effect on the quality of the human environment. | No <u> X </u> | Uncertain <u> </u> | Yes |
| 2. This action would have highly controversial environmental effects or involve unresolved conflicts concerning alternative uses of available resources. | No <u> X </u> | Uncertain <u> </u> | Yes |

Evaluation of Exemptions to Actions within Categorical Exclusion

- | | | | |
|--|-----------------|-------------------------|-----|
| 1. This action would have significant adverse effects on public health or safety. | No <u> X </u> | Uncertain <u> </u> | Yes |
| 2. This action would have significant impacts on such natural resources and unique geographical characteristics as historic or cultural resources; parks, recreation, and refuge lands; wilderness areas; wild or scenic rivers; national natural landmarks; sole or principal drinking water aquifers; prime farmlands; wetlands; floodplains; national monuments; migratory birds; and other ecologically significant or critical areas. | No <u> X </u> | Uncertain <u> </u> | Yes |
| 3. This action would have highly uncertain and potentially significant environmental effects or involve unique or unknown environmental risks. | No <u> X </u> | Uncertain <u> </u> | Yes |
| 4. This action would establish a precedent for future action or represent a decision in principle about future actions with potentially significant environmental effects. | No <u> X </u> | Uncertain <u> </u> | Yes |

- | | | | |
|--|-----------------|-------------------------|-----|
| 5. This action would have a direct relationship to other actions with individually insignificant but cumulatively significant environmental effects. | No <u> X </u> | Uncertain <u> </u> | Yes |
| | | | |
| 6. This action would have significant impacts on properties listed, or eligible for listing, on the National Register of Historic Places as determined by the bureau (in coordination with a Reclamation cultural resources professional). | No <u> X </u> | Uncertain <u> </u> | Yes |
| | | | |
| 7. This action would have significant impacts on species listed, or proposed to be listed, on the List of Endangered or Threatened Species, or have significant impacts on designated critical habitat for these species. | No <u> X </u> | Uncertain <u> </u> | Yes |
| | | | |
| 8. This action would violate a Federal, State, local, or tribal law or requirement imposed for protection of the environment. | No <u> X </u> | Uncertain <u> </u> | Yes |
| | | | |
| 9. This action would affect Indian Trust Assets (ITA) (To be completed by Reclamation official responsible for ITA). | No <u> X </u> | Uncertain <u> </u> | Yes |
| | | | |
| 10. This action would have a disproportionately high and adverse effect on low income or minority populations. | No <u> X </u> | Uncertain <u> </u> | Yes |
| | | | |
| 11. This action would limit access to and ceremonial use of Indian sacred sites on Federal lands by Indian religious practitioners or significantly adversely affect the physical integrity of such sacred sites. | No <u> X </u> | Uncertain <u> </u> | Yes |

12. This action would contribute to the introduction, continued existence, or spread of noxious weeds or non-native invasive species known to occur in the area or actions that may promote the introduction, growth, or expansion of the range of such species. No X Uncertain Yes

NEPA Action: Categorical Exclusion X

Environmental commitments, explanation, and/or remarks:

☐ Yes ☒ No Environmental commitments are required and attached.

☐ San Joaquin Kit Fox Avoidance and Minimization Measures

☐ Giant Garter Snake Avoidance and Minimization Measures

☐ California Tiger Salamander Avoidance and Minimization Measures

☐ California Red-Legged Frog Avoidance and Minimization Measures

☐ Other:

Air Quality:

Contractors hired by CDPR would follow best management practices outlined by CDPR to control fugitive dust and minimize air quality impacts.

Prepared by:

Rain Healer

Date: October 20, 2010

South-Central California Area Office

Regional Archeologist concurrence with Item 7:
See attachment.

ITA Designee concurrence with Item 10:
See attachment.

Concur:

Shanna Mc Donald

Date: 4/27/11

Wildlife Biologist, South-Central California Area Office

Concur:

[Signature]

Date: 4/27/11

Supervisory Natural Resources Specialist, South-Central California Area Office

Concur:

Randy J English

Date: 4/28/11

Chief, Resources Management Division, South-Central California Area Office

Approved:

Laura Myers

Date: 4/28/11

Deputy Area Manager, South-Central California Area Office