

5.31 Jeff Mancebo

DRAFT LANDOWNER COMMENT LETTER TO BUREAU OF RECLAMATION

[Date] 6-23-09

JUN 25, 2009

CODE	ACTION	DATE
170	<input checked="" type="checkbox"/>	

Mr. Jason Phillips
SJRRP Program Manager
U.S. Bureau of Reclamation
2800 Cottage Way, MP-170
Sacramento, CA 95825-1898
InterimFlows@restoresjr.net

RE: **Environmental Analysis for the San Joaquin River Restoration Program**

Dear Mr. Phillips:

I am interested in the environmental review process for the above-referenced proceeding. Please include this letter and comments for the record in this environmental review process.

MANCEBO-1 I hereby join in the comments submitted by the San Joaquin River Resource Management Coalition (RMC). The purpose of this letter is to fulfill my obligation to exhaust administrative remedies. Whether or not I choose to raise all issues raised by the RMC or others will be determined at a later time.

Sincerely yours,

Jeff Mancebo

Name: Jeff Mancebo
Address: 15385 N. Newcomb Rd.
City: Das Palos, CA 95620
Assessor's Parcel No(s).: 003-100-22
003-100-215
003-100-26

Classification	ENV 60
Project	214
Control No.	09037118
Folder ID	1019105
Date Input & Initials	6-25-09 <i>fy</i>

Responses to Comments from Jeff Mancebo

Mancebo-1: See responses to comments from the San Joaquin River Resource Management Coalition (Chapter 3).

5.32 Gary Martin

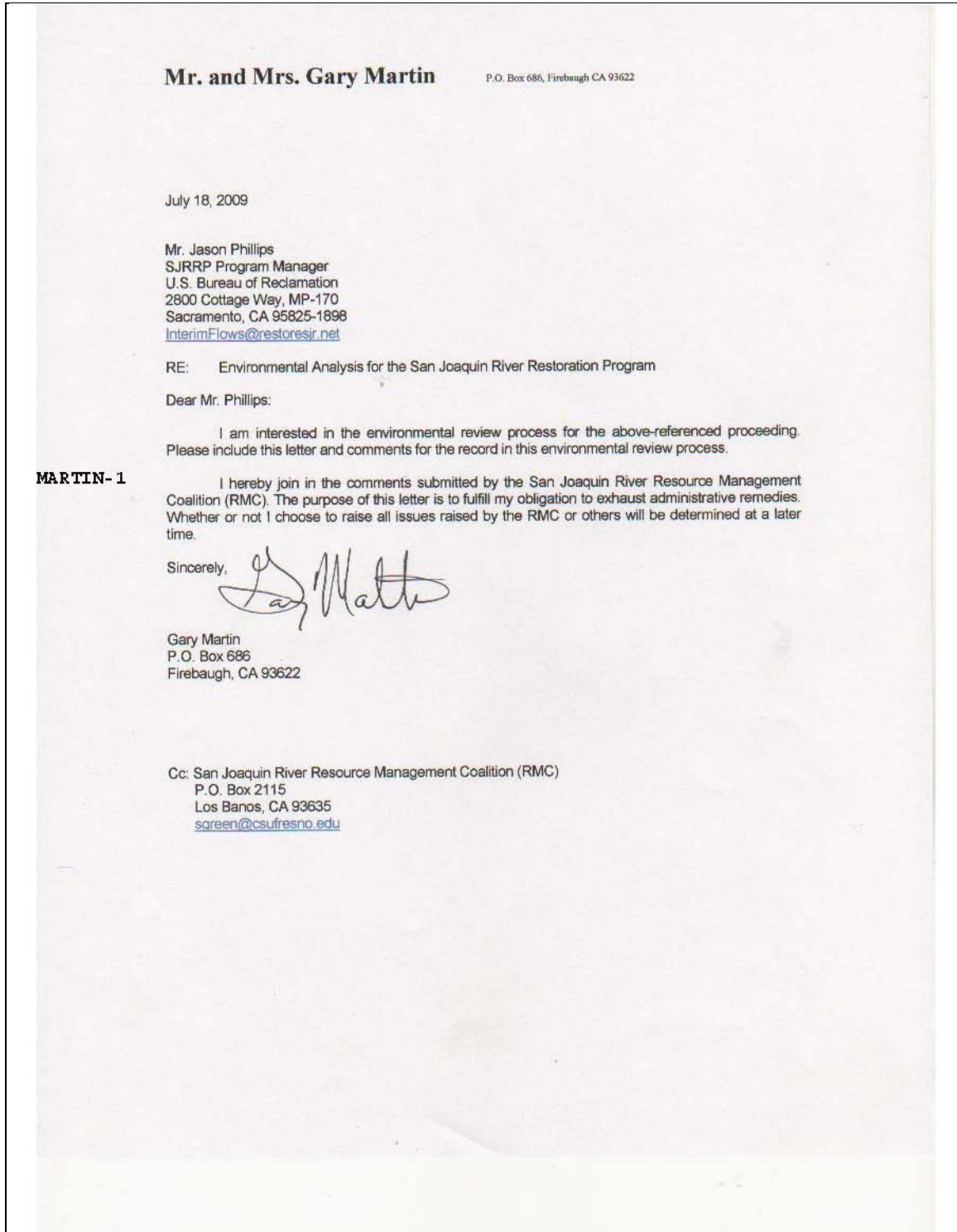

Responses to Comments from Gary Martin

Martin-1: See responses to comments from the San Joaquin River Resource Management Coalition (Chapter 3).

5.33 Daniel F. McNamara, The Forbes, Yore & McGinn Corporation

	17 09 02:00p	Dan McNamara	(209) 726-8658	p.1
 The Forbes, Yore & McGinn Corporation P. O Box 2985 Merced, CA 95344 (209) 383-1412 w (209) 761-2473 c (209) 726-8658 FAX dfmac5@aol.com <u>To: Bureau of Reclamation</u> <u>Attn: Jason Phillips</u> <u>Fax: (916) 978-5094</u> <u>Phone: (916) 418-8248</u> Jason,				
<u>From: Dan McNamara</u> <u>Pages: 10</u> <u>Date: 6/17/09</u>				

San Joaquin River Restoration Program

Jun 17 09 02:00p

Dan McNamara

(209) 726-8658

p.2

6/17/09

Mr. Jason Phillips
SJRRP Program Manager
U.S. Bureau of Reclamation
2800 Cottage Way, MP-170
Sacramento, CA 95825-1898
InterimFlows@restoresjr.net

RE: *Environmental Analysis for the San Joaquin River Restoration Program*

Dear Mr. Phillips:

I am interested in the environmental review process for the above-referenced proceeding. Please include this letter and comments for the record in this environmental review process.

MCNAMARA-1 I hereby join in the comments submitted by the San Joaquin River Resource Management Coalition (RMC). The purpose of this letter is to fulfill my obligation to exhaust administrative remedies. Whether or not I choose to raise all issues raised by the RMC or others will be determined at a later time.

Sincerely yours,

 PRESIDENT

DANIEL F. MCNAMARA and

Name: THE FORBES, YORE & MCNAMARA CORPORATION
Address: P.O. BOX 2985
City: MERCED, CA 95344
Assessor's Parcel No(s): 074-010-007
-008
-009
-010
-020-004
-005

Jun 17 09 02:00p

Dan McNamara

(209) 726-8658

p.3

MACNAMARA - 2

**SURVEY REGARDING POTENTIAL IMPACTS OF SAN JOAQUIN RIVER
RESTORATION PROGRAM**

Please submit 1 survey for each property you own.

Name: DANIEL F. McNAMARA and
Address: THE FORBES, YORE & MILGWIN CORPORATION
City: P.O. BOX 2985
Assessor's Parcel No(s): MERLEDA, CA 95344
074-020-005

Contact Information:

Telephone Number: (209) 283-1412
Cell Phone Number: (209) 781-2473
Email Address: DFM@ESTO.FPL.COM

Please provide responses to each of the following questions:

1. For each APN identified above, please specify the approximate distance from the river for each parcel.

APNs:

Distance from river:

074-020-005 BORDERS RIVER FOR 1/2 MILE

2. The current uses of the property described above are for:

☒ Annual crops
☐ Trees
☐ Vines
☐ Commercial
☐ Industrial
☒ Residential
☐ Governmental
☐ Wildlife refuge
☐ Other (please explain)

Jun 17 09 02:01p

Dan McNamara

(209) 726-8658

p.4

3. Based upon your experience, if river flows are expected to range from approximately 475 cfs to 1300 cfs during the course of a year, what impacts are likely to be experienced on your property(s):

- ☒ High groundwater that saturates the root zone
- ☒ High groundwater that causes surface flooding
- ☒ Other seepage impacts impeding farming practices
- ☒ Flooding
- ☐ Increased levee maintenance requirements - THERE HAVE NEVER BEEN LEVEES IN THIS AREA
- ☐ Increases to groundwater levels with no adverse impact to crops or surface conditions
- ☒ Loss of riparian zone
- ☐ Enhanced riparian zone

4. If you anticipate losing any real property as a result of the flow increases, please provide your best estimate as to the amount of property that will be lost and describe how the loss will occur.

- a. Acreage lost: THE DISTANCE OF A NEW LEVEE FROM THE EDGE OF THE
SJR MULTIPLIED TIMES 1/2 MILE DISTANCE BORDERING THE RIVER.
- b. Explanation: IE IF LEVEE IS 1,150 FEET FROM RIVER X 2,640 FEET LONG = 69.7 ACRES.
THIS LOST ACREAGE INCLUDES THE 7 LANDSCAPED ACRES MY PRINCIPAL
RESIDENCE AND OTHER BUILDINGS ARE LOCATED ON. THE OTHER BUILDINGS
INCLUDE AN EMPLOYEE HOUSE, A BARN, AND A GARAGE WITH A BEDROOM AND
BATH ROOM ABOVE. THERE IS ALSO A SWIMMING POOL.
THERE WILL PROBABLY BE LOST CROP PRODUCTION BEYOND THE LEVEE.

2 074-020-005

Jun 17 09 02:01p

Dan McNamara

(209) 726-8658

p.5

**SURVEY REGARDING POTENTIAL IMPACTS OF SAN JOAQUIN RIVER
RESTORATION PROGRAM**

Please submit 1 survey for each property you own.

Name: THE FORBES, YORKE & MCGINNIS CORPORATION
Address: P.O. BOX 2985
City: MERCED, CA 95244
Assessor's Parcel No(s): 074-020-004

Contact Information:

Telephone Number: (209) 383-1412
Cell Phone Number: (209) 761-2473
Email Address: DEMBRO@ADL.COM

Please provide responses to each of the following questions:

1. For each APN identified above, please specify the approximate distance from the river for each parcel.

APNs:	Distance from river:
<u>074-020-004</u>	<u>BORDERS RIVER FOR 3/4 MILE</u>
_____	_____
_____	_____

2. The current uses of the property described above are for:

☒ Annual crops
☐ Trees
☐ Vines
☐ Commercial
☐ Industrial
☐ Residential
☐ Governmental
☐ Wildlife refuge
☐ Other (please explain)

Jun 17 09 02:01p

Dan McNamara

(209) 726-8658

p.6

3. Based upon your experience, if river flows are expected to range from approximately 475 cfs to 1300 cfs during the course of a year, what impacts are likely to be experienced on your property(s):

- ☒ High groundwater that saturates the root zone
- ☒ High groundwater that causes surface flooding
- ☒ Other seepage impacts impeding farming practices
- ☒ Flooding
- ☐ Increased levee maintenance requirements - *THERE HAVE NEVER BEEN LEVES IN THIS AREA*
- ☐ Increases to groundwater levels with no adverse impact to crops or surface conditions
- ☒ Loss of riparian zone
- ☐ Enhanced riparian zone

4. If you anticipate losing any real property as a result of the flow increases, please provide your best estimate as to the amount of property that will be lost and describe how the loss will occur.

- a. Acreage lost: *THE DISTANCE OF A NEW LEVEE FROM THE EDGE OF THE*
SJR MULTIPLIED TIMES APPROXIMATELY 3/4 MILE (BECAUSE OF
b. Explanation: *THE HORSESHOE SHAPE) DISTANCE BORDERING THE RIVER.*
IE IF THE LEVEE IS 1,150 FEET FROM THE RIVER X 3,960 FEET LONG = 104.51 ACRES.
THERE WILL PROBABLY BE LOST CROP PRODUCTION BEYOND THE LEVEE.

2 074-020-004

Jun 17 09 02:01p

Dan McNamara

(209) 726-8658

p.7

**SURVEY REGARDING POTENTIAL IMPACTS OF SAN JOAQUIN RIVER
RESTORATION PROGRAM**

Please submit 1 survey for each property you own.

Name: THE FORGES, YURE & MCGINN CORPORATION
Address: P.O. BOX 2985
City: MERLEDA, CA 95344
Assessor's Parcel No(s).: 074-010-007
- 010

Contact Information:

Telephone Number: (209) 383-1412
Cell Phone Number: (209) 761-2423
Email Address: dmcnamara@50apl.com

Please provide responses to each of the following questions:

1. For each APN identified above, please specify the approximate distance from the river for each parcel.

APNs:

Distance from river:

<u>074-010-007</u>	<u>841 FEET AT CLOSEST POINT</u>
<u>- 010</u>	<u>7/8 MILE</u>

2. The current uses of the property described above are for:

☒ Annual crops
☐ Trees
☐ Vines
☐ Commercial
☐ Industrial
☐ Residential
☐ Governmental
☐ Wildlife refuge
☐ Other (please explain)

Jun 17 09 02:02p

Dan McNamara

(209) 726-8658

p.8

3. Based upon your experience, if river flows are expected to range from approximately 475 cfs to 1300 cfs during the course of a year, what impacts are likely to be experienced on your property(s):

- ☒ High groundwater that saturates the root zone
- ☐ High groundwater that causes surface flooding
- ☒ Other seepage impacts impeding farming practices
- ☒ Flooding
- ☐ Increased levee maintenance requirements
- ☐ Increases to groundwater levels with no adverse impact to crops or surface conditions
- ☐ Loss of riparian zone
- ☐ Enhanced riparian zone

4. If you anticipate losing any real property as a result of the flow increases, please provide your best estimate as to the amount of property that will be lost and describe how the loss will occur.

- a. Acreage lost: ?
- b. Explanation: *THERE WILL PROBABLY BE LOST CROP PRODUCTION BEYOND THE LEVEE.*

2 074-01P-007
-210

Jun 17 09 02:02p

Dan McNamara

(209) 726-8658

p.9

**SURVEY REGARDING POTENTIAL IMPACTS OF SAN JOAQUIN RIVER
RESTORATION PROGRAM**

Please submit 1 survey for each property you own.

Name: THE FORBES, YDRE E. MC GIMAN CORPORATION
Address: P.O. BOX 2996
City: MERCED, CA 95354
Assessor's Parcel No(s): 074-010-008
-009

Contact Information:

Telephone Number: (209) 253-1412
Cell Phone Number: (209) 761-2473
Email Address: DEMAK5@AOL.COM

Please provide responses to each of the following questions:

1. For each APN identified above, please specify the approximate distance from the river for each parcel.

APNs:	Distance from river:
<u>074-010-008</u>	<u>4,800 FEET AT THE CLOSEST POINT</u>
<u>-009</u>	<u>4,800 " " " " "</u>

2. The current uses of the property described above are for:

☒ Annual crops
☐ Trees
☐ Vines
☐ Commercial
☐ Industrial
☐ Residential
☐ Governmental
☐ Wildlife refuge
☐ Other (please explain)

Jun 17 09 02:02p

Dan McNamara

(209) 726-8658

p.10

3. Based upon your experience, if river flows are expected to range from approximately 475 cfs to 1300 cfs during the course of a year, what impacts are likely to be experienced on your property(s):

- ☒ High groundwater that saturates the root zone
- ☐ High groundwater that causes surface flooding
- ☒ Other seepage impacts impeding farming practices
- ☒ Flooding
- ☐ Increased levee maintenance requirements
- ☐ Increases to groundwater levels with no adverse impact to crops or surface conditions
- ☐ Loss of riparian zone
- ☐ Enhanced riparian zone

4. If you anticipate losing any real property as a result of the flow increases, please provide your best estimate as to the amount of property that will be lost and describe how the loss will occur.

a. Acreage lost: ?

b. Explanation: *THERE WILL PROBABLY BE LOST CROP PRODUCTION BEYOND THE LEVEE.*

2 074-D12-008
009

**Responses to Comments from Daniel F. McNamara,
The Forbes, Yore & McGinn Corporation**

McNamara-1, and -2: See responses to comments from the San Joaquin River Resource Management Coalition (Chapter 3).

5.34 James L. Nickel, Nickel Family LLC (Fresno County)



15701 Highway 178 • P.O. Box 60679 • Bakersfield, CA 93386-0679
(661) 872-5050 • Fax: (661) 872-7141

June 22, 2009

Mr. Jason Phillips
SJRRP Program Manager
US Bureau of Reclamation
2800 Cottage Way, MP-170
Sacramento CA 95825-1898
InterFlows@restoresir.net

RE: Environmental Analysis for the San Joaquin River Restoration Program

Dear Mr. Phillips:

I am interested in the environmental review process for the above-reference proceeding. Please include this letter and comments for the record in this environmental review process.

NFC-1 I hereby join in the comments submitted by the San Joaquin River Resource Management Coalition (RMC). The purpose of this letter is to fulfill my obligation to exhaust administrative remedies. Whether or not I choose to raise all issues raised by the RMC or others will be determined at a later time.

Sincerely,

NICKEL FAMILY LLC

By: 
James L. Nickel, President

Assessor's Parcel No.: Fresno County
03-220-130

**Responses to Comments from James L. Nickel, Nickel Family LLC
(Fresno County)**

NFC-1: See responses to comments from the San Joaquin River Resource Management Coalition (Chapter 3).

5.35 James L. Nickel, Nickel Family LLC (Merced County)

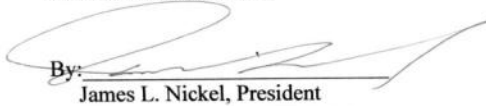
 NICKEL FAMILY LLC		15701 Highway 178 • P. O. Box 60679 • Bakersfield, CA 93386-0679 (661) 872-5050 • Fax: (661) 872-7141																																																											
<p>June 22, 2009</p> <p>Mr. Jason Phillips SJRRP Program Manager US Bureau of Reclamation 2800 Cottage Way, MP-170 Sacramento CA 95825-1898 InterFlows@restoresir.net</p> <p>RE: Environmental Analysis for the San Joaquin River Restoration Program</p> <p>Dear Mr. Phillips:</p> <p>I am interested in the environmental review process for the above-reference proceeding. Please include this letter and comments for the record in this environmental review process.</p> <p>NMC - 1 I hereby join in the comments submitted by the San Joaquin River Resource Management Coalition (RMC). The purpose of this letter is to fulfill my obligation to exhaust administrative remedies. Whether or not I choose to raise all issues raised by the RMC or others will be determined at a later time.</p> <p>Sincerely,</p> <p>NICKEL FAMILY LLC</p> <p>By:  James L. Nickel, President</p> <p>Assessor's Parcel Nos.:</p> <table border="0"><tr><td><u>Merced County</u></td><td></td></tr><tr><td><u>073350001000</u></td><td><u>073400022000</u></td></tr><tr><td><u>073350002000</u></td><td><u>073400024000</u></td></tr><tr><td><u>073360014000</u></td><td><u>073400027000</u></td></tr><tr><td><u>073390018000</u></td><td><u>073410003000</u></td></tr><tr><td><u>073400009000</u></td><td><u>073410005000</u></td></tr><tr><td><u>073400020000</u></td><td><u>073410006000</u></td></tr><tr><td></td><td><u>085370017000</u></td></tr></table> <p style="text-align: right;">NOTICE: IF YOU DETACH ENCLOSURE PLEASE INSERT</p> <p>CODE NO. _____ INITIAL _____ DATE _____</p> <table border="1" style="float: right; margin-top: 20px;"><tr><td colspan="3" style="text-align: center;">BUREAU OF RECLAMATION OFFICIAL FILE COPY RECEIVED</td></tr><tr><td colspan="3" style="text-align: center;">JUN 26 2009</td></tr><tr><td>CODE</td><td>ACTION</td><td>SURNAME & DATE</td></tr><tr><td>170</td><td>✓</td><td></td></tr><tr><td> </td><td> </td><td> </td></tr><tr><td> </td><td> </td><td> </td></tr><tr><td> </td><td> </td><td> </td></tr><tr><td> </td><td> </td><td> </td></tr><tr><td> </td><td> </td><td> </td></tr><tr><td> </td><td> </td><td> </td></tr><tr><td> </td><td> </td><td> </td></tr></table> <table border="1" style="float: right; margin-top: 20px;"><tr><td>Classification</td><td>ENV-6.00</td></tr><tr><td>Project</td><td>214</td></tr><tr><td>Control No.</td><td>09037445</td></tr><tr><td>Folder I.D.</td><td>1019105</td></tr><tr><td>Date Input & Initials</td><td>6/25/09</td></tr></table>			<u>Merced County</u>		<u>073350001000</u>	<u>073400022000</u>	<u>073350002000</u>	<u>073400024000</u>	<u>073360014000</u>	<u>073400027000</u>	<u>073390018000</u>	<u>073410003000</u>	<u>073400009000</u>	<u>073410005000</u>	<u>073400020000</u>	<u>073410006000</u>		<u>085370017000</u>	BUREAU OF RECLAMATION OFFICIAL FILE COPY RECEIVED			JUN 26 2009			CODE	ACTION	SURNAME & DATE	170	✓																							Classification	ENV-6.00	Project	214	Control No.	09037445	Folder I.D.	1019105	Date Input & Initials	6/25/09
<u>Merced County</u>																																																													
<u>073350001000</u>	<u>073400022000</u>																																																												
<u>073350002000</u>	<u>073400024000</u>																																																												
<u>073360014000</u>	<u>073400027000</u>																																																												
<u>073390018000</u>	<u>073410003000</u>																																																												
<u>073400009000</u>	<u>073410005000</u>																																																												
<u>073400020000</u>	<u>073410006000</u>																																																												
	<u>085370017000</u>																																																												
BUREAU OF RECLAMATION OFFICIAL FILE COPY RECEIVED																																																													
JUN 26 2009																																																													
CODE	ACTION	SURNAME & DATE																																																											
170	✓																																																												
Classification	ENV-6.00																																																												
Project	214																																																												
Control No.	09037445																																																												
Folder I.D.	1019105																																																												
Date Input & Initials	6/25/09																																																												

**Responses to Comments from James L. Nickel, Nickel Family LLC
(Merced County)**

NMC-1: See responses to comments from the San Joaquin River Resource Management Coalition (Chapter 3).

5.36 James O'Banion, O'Banion Ranches

O'Banion Ranches
P.O. BOX 127
DOS PALOS, CALIF. 93620

170 ✓ JP 4/30/09

Mr. Jason Phillips
SJRRP Program Manager
U.S. Bureau of Reclamation
2800 Cottage Way, MP-170
Sacramento, CA 95825-1898
InterimFlows@restoresjr.net

RE: *Environmental Analysis for the San Joaquin River Restoration Program*

Dear Mr. Phillips:

I am interested in the environmental review process for the above-referenced proceeding. Please include this letter and comments for the record in this environmental review process.

OBR-1 I hereby join in the comments submitted by the San Joaquin River Resource Management Coalition (RMC). The purpose of this letter is to fulfill my obligation to exhaust administrative remedies. Whether or not I choose to raise all issues raised by the RMC or others will be determined at a later time.

Sincerely yours,



Name: James O'Banion ETAL
Address: P.O. Box 127
City: Dos Palos, Ca 93620
Assessor's Parcel No(s): 003-210-03 003-220-10 003-100-08-19-04
003-110-27-28 85-370-08 85-270-020
73-360-002-003 73-390-003-008
85-070-001-025 85-060-003-009-010
85-160-006-009-010 85-230-005
86-070-005 86-080-006-007 89-090-006
001-110-020-14 001-120-03-08-07-05
001-060-05-004 001-140-05-04

ENV-6.00
214
09036489
1619105
6/23/09

Responses to Comments from James O'Banion, O'Banion Ranches

OBR-1: See responses to comments from the San Joaquin River Resource Management Coalition (Chapter 3).

5.37 William D. Phillimore, Paramount Farming Company

<p>33141 E. Lerdo Highway Bakersfield, CA 93308-9767</p>	 <p>PARAMOUNT FARMING COMPANY</p>	<p>Bus: (661) 399-4456 Fax: (661) 399-1735</p>
--	--	--

June 23, 2009

Mr. Jason Phillips
SJRRP Program Manager
U. S. Bureau of Reclamation
2800 Cottage Way, MP-170
Sacramento, CA 95825-1898
InterimFlows@restoresjr.net

Re: ***Environmental Analysis for San Joaquin River Restoration Project***
[Assessor's Parcel No(s): 042-191-001, 042-192-001, 042-220-004, 042-221-001, 042-231-002, 042-231-006, 042-231-007, 042-231-008, 042-232-001, 042-241-001, 042-241-002, 042-252-003, 042-260-003, 042-270-001, and 042-280-002]

Dear Mr. Phillips:

I am interested in the environmental review process for the above-referenced proceeding. Please include this letter and comments for the record in this environmental review process.

PFC-1 I hereby join in the comments submitted by the San Joaquin River Resource Management Coalition (RMC). The purpose of this letter is to fulfill my obligation to exhaust administrative remedies. Whether or not I choose to raise all issues raised by the RMC or others will be determined at a later time.

Sincerely,



William D. Phillimore
Executive Vice President

WDP/et

**Responses to Comments from William D. Phillimore,
Paramount Farming Company**

PFC-1: See responses to comments from the San Joaquin River Resource Management Coalition (Chapter 3).

5.38 Jack L. Perry and Patricia A. Perry

BUREAU OF RECLAMATION OFFICIAL FILE COPY RECEIVED		
JUL 5 7 2009		
CBS	ACTION	SURNAME & DATE
170	✓	

DRAFT LANDOWNER COMMENT LETTER TO BUREAU OF RECLAMATION

[Date]

Mr. Jason Phillips
SJRRP Program Manager
U.S. Bureau of Reclamation
2800 Cottage Way, MP-170
Sacramento, CA 95825-1898
InterimFlows@restoresjr.net

RE: *Environmental Analysis for the San Joaquin River Restoration Program*

Dear Mr. Phillips:

I am interested in the environmental review process for the above-referenced proceeding. Please include this letter and comments for the record in this environmental review process.

Perry-1 I hereby join in the comments submitted by the San Joaquin River Resource Management Coalition (RMC). The purpose of this letter is to fulfill my obligation to exhaust administrative remedies. Whether or not I choose to raise all issues raised by the RMC or others will be determined at a later time.

Sincerely yours,

Name:
Address:
City:
Assessor's Parcel No(s):

Jack L. Perry Patricia A. Perry
P.O. Box 65
Firebaugh, CA 93622
042-010-046-000
042-010-047-000

Control No.	09029360
Folder ID	101970
Date Input & Initials	12-1-09

Columbia Canal Company
6770 Ave. 7 1/2
Firebaugh, CA 93622

Responses to Comments from Jack L. Perry and Patricia A. Perry

Perry-1: See responses to comments from the San Joaquin River Resource Management Coalition (Chapter 3).

5.39 Mari Locke Martin, Pikalok Farming

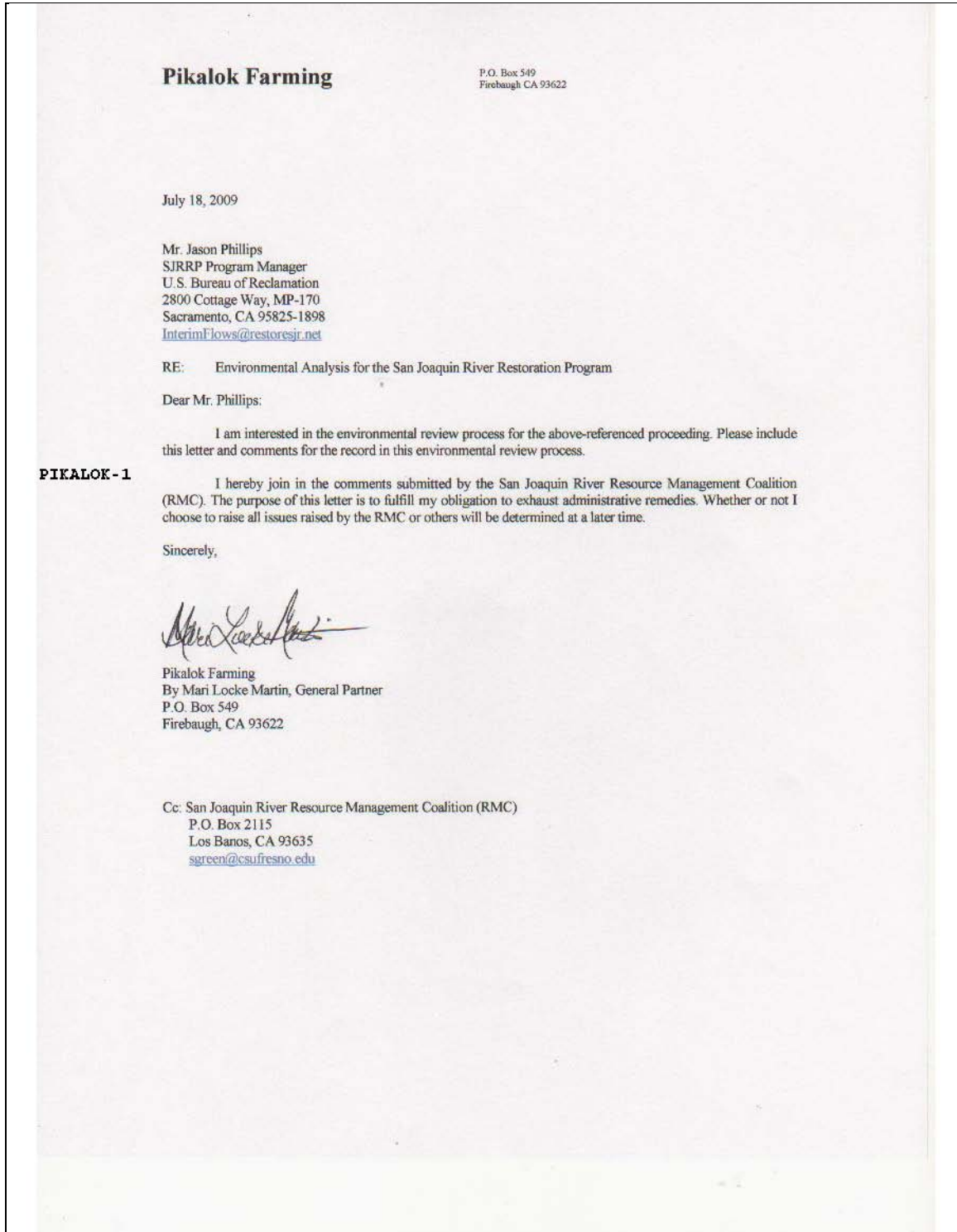

Responses to Comments from Mari Locke Martin, Pikalok Farming

Pikalok-1: See responses to comments from the San Joaquin River Resource Management Coalition (Chapter 3).

5.40 Gary M. Pirtle

DRAFT LANDOWNER COMMENT LETTER TO BUREAU OF RECLAMATION		
[Date]		
<p>Mr. Jason Phillips SJRRP Program Manager U.S. Bureau of Reclamation 2800 Cottage Way, MP-170 Sacramento, CA 95825-1898 InterimFlows@restoresjr.net</p>		
RE: <i>Environmental Analysis for the San Joaquin River Restoration Program</i>		
Dear Mr. Phillips:		
<p>I am interested in the environmental review process for the above-referenced proceeding. Please include this letter and comments for the record in this environmental review process.</p>		
<p>PIRTLE-1 I hereby join in the comments submitted by the San Joaquin River Resource Management Coalition (RMC). The purpose of this letter is to fulfill my obligation to exhaust administrative remedies. Whether or not I choose to raise all issues raised by the RMC or others will be determined at a later time.</p>		
Sincerely yours,		
<p>Name: <u>GARY M. PIRTLE</u> Address: <u>6419 ROAD 24</u> City: <u>MADERA CALIF 93637</u> Assessor's Parcel No(s): <u>041-190-001-000</u> <u>041-130-002-000</u> <u>041-130-007-000</u></p>		
<p>ENV 6-02 Project: 214 Control No. 09039386 Folder ID 1019105 Date Input & Initials 9-9-09</p>		

Responses to Comments from Gary M. Pirtle

Pirtle-1: See responses to comments from the San Joaquin River Resource Management Coalition (Chapter 3).

5.41 Ranch Holdings One LLP

DRAFT LANDOWNER COMMENT LETTER TO BUREAU OF RECLAMATION

[Date]

Mr. Jason Phillips
SJRRP Program Manager
U.S. Bureau of Reclamation
2800 Cottage Way, MP-170
Sacramento, CA 95825-1898
InterimFlows@restoresjr.net

RE: **Environmental Analysis for the San Joaquin River Restoration Program**

Dear Mr. Phillips:

I am interested in the environmental review process for the above-referenced proceeding. Please include this letter and comments for the record in this environmental review process.

RHO-1 I hereby join in the comments submitted by the San Joaquin River Resource Management Coalition (RMC). The purpose of this letter is to fulfill my obligation to exhaust administrative remedies. Whether or not I choose to raise all issues raised by the RMC or others will be determined at a later time.

Sincerely yours,

RANCH HOLDINGS ONE LLP
by Ryan [signature] MANAGER

contact Name: Ranch Holdings ONE LLP
Address: 9100 Hwy 145
City: MADRERA, CA 95627
Assessor's Parcel No(s): 040-180-012

ENV 600
244
09039447
10/9/09
10/9/09

BUREAU OF RECLAMATION
OFFICIAL FILE COPY
RECEIVED
JUL 07 2009

CODE	ACTION	SURNAME & DATE
170	1	

Columbia Canal Company
6770 Ave. 7 1/2

Responses to Comments from Ranch Holdings One LLP

RHO-1: See responses to comments from the San Joaquin River Resource Management Coalition (Chapter 3).

5.42 Suzanne Redfern-West, Redfern Ranches, Inc.

REDFERN RANCHES, INC.																																					
P.O. BOX 305 DOS PALOS, CALIFORNIA 93620 OFFICE TELEPHONE (209) 392-2426 • RESIDENCE TELEPHONE (650) 324-2082 E-mail: suzyredf@pacbell.net																																					
SUZANNE REDFERN-WEST																																					
July 16, 2009																																					
<table border="1" style="border-collapse: collapse;"><tr><td colspan="3" style="text-align: center;">BUREAU OF RECLAMATION OFFICIAL FILE COPY RECEIVED</td></tr><tr><td colspan="3" style="text-align: center;">JUL 17 2009</td></tr><tr><td>CODE</td><td>ACTION</td><td>SURNAME & DATE</td></tr><tr><td>1510</td><td style="text-align: center;">✓</td><td></td></tr><tr><td> </td><td> </td><td> </td></tr><tr><td> </td><td> </td><td> </td></tr><tr><td> </td><td> </td><td> </td></tr><tr><td> </td><td> </td><td> </td></tr><tr><td> </td><td> </td><td> </td></tr><tr><td> </td><td> </td><td> </td></tr><tr><td> </td><td> </td><td> </td></tr><tr><td> </td><td> </td><td> </td></tr></table>		BUREAU OF RECLAMATION OFFICIAL FILE COPY RECEIVED			JUL 17 2009			CODE	ACTION	SURNAME & DATE	1510	✓																									
BUREAU OF RECLAMATION OFFICIAL FILE COPY RECEIVED																																					
JUL 17 2009																																					
CODE	ACTION	SURNAME & DATE																																			
1510	✓																																				
<p>Mr. Jason Phillips SJRRP Program Manager U.S. Bureau of Reclamation 2800 Cottage Way, MP-170 Sacramento, CA 95825-1898 InterimFlows@restoresjr.net</p>																																					
<p>RE: <i>Environmental Analysis for the San Joaquin River Restoration Program</i></p>																																					
<p>Dear Mr. Phillips:</p>																																					
<p>As a landowner and farmer along the San Joaquin River, I am interested in the environmental review process for the above-referenced proceeding. Please include this letter and comments for the record in this environmental review process.</p>																																					
REDPERN-1	<p>I hereby join in the comments submitted by the San Joaquin River Resource Management Coalition (RMC). The purpose of this letter is to fulfill my obligation to exhaust administrative remedies. Whether or not I choose to raise all issues raised by the RMC or others will be determined at a later time.</p>																																				
<p>Yours truly,</p>																																					
																																					
<p>Suzanne Redfern-West 1350 Forest Avenue Palo Alto, CA 94301</p>																																					
<table border="1" style="border-collapse: collapse;"><tr><td>Classification</td><td>ENV600</td></tr><tr><td>Project</td><td>214</td></tr><tr><td>Control No.</td><td>0904 2232</td></tr><tr><td>Folder ID</td><td>10 9105</td></tr><tr><td>Date Input & Initials</td><td>7-17-09 SP</td></tr></table>		Classification	ENV600	Project	214	Control No.	0904 2232	Folder ID	10 9105	Date Input & Initials	7-17-09 SP																										
Classification	ENV600																																				
Project	214																																				
Control No.	0904 2232																																				
Folder ID	10 9105																																				
Date Input & Initials	7-17-09 SP																																				
<p>Assessor's Parcel Numbers: (Fresno County) 001-220-13; 003-100-29S; 003-100-36S; 003-200-03S; 003-200-07S; 003-200-04S</p>																																					

5

**Responses to Comments from Suzanne Redfern-West,
Redfern Ranches, Inc.**

Redfern-1: See responses to comments from the San Joaquin River Resource Management Coalition (Chapter 3).

5.43 Gerald Roberts

DRAFT LANDOWNER COMMENT LETTER TO BUREAU OF RECLAMATION

[Date]

Mr. Jason Phillips
SJRRP Program Manager
U.S. Bureau of Reclamation
2800 Cottage Way, MP-170
Sacramento, CA 95825-1898
InterimFlows@restoresjr.net

RE: *Environmental Analysis for the San Joaquin River Restoration Program*

Dear Mr. Phillips:

I am interested in the environmental review process for the above-referenced proceeding. Please include this letter and comments for the record in this environmental review process.

ROBERTS-1 I hereby join in the comments submitted by the San Joaquin River Resource Management Coalition (RMC). The purpose of this letter is to fulfill my obligation to exhaust administrative remedies. Whether or not I choose to raise all issues raised by the RMC or others will be determined at a later time.

Sincerely yours,

Name:
Address:
City:
Assessor's Parcel No(s):

Gerald Roberts
4871 N. Humboldt
Reimer CA 93630

ROBERTS-2

**SURVEY REGARDING POTENTIAL IMPACTS OF SAN JOAQUIN RIVER
RESTORATION PROGRAM**

Please submit 1 survey for each property you own.

Name:

Address:

City:

Assessor's Parcel No(s):

JR Farms
Carol Roberts
4871 N. Humboldt
Kerman CA 93630

Contact Information:

Telephone Number:

Cell Phone Number:

Email Address:

559-907-5774

Please provide responses to each of the following questions:

1. For each APN identified above, please specify the approximate distance from the river for each parcel.

APNs:

Distance from river:

NE Corner Humboldt & Shaw
SW Corner Humboldt & Shaw

1/2 mile
1/2 mile

2. The current uses of the property described above are for:

☒ Annual crops
☐ Trees
☐ Vines
☐ Commercial
☐ Industrial
☐ Residential
☐ Governmental
☐ Wildlife refuge
☐ Other (please explain)

3. Based upon your experience, if river flows are expected to range from approximately 475 cfs to 1300 cfs during the course of a year, what impacts are likely to be experienced on your property(s):

☐ High groundwater that saturates the root zone
☐ High groundwater that causes surface flooding
☐ Other seepage impacts impeding farming practices
☐ Flooding
☐ Increased levee maintenance requirements
☐ Increases to groundwater levels with no adverse impact to crops or surface conditions
☐ Loss of riparian zone
☐ Enhanced riparian zone

4. If you anticipate losing any real property as a result of the flow increases, please provide your best estimate as to the amount of property that will be lost and describe how the loss will occur.

a. Acreage lost:

b. Explanation:

Responses to Comments from Gerald Roberts

Roberts-1, and -2: See responses to comments from the San Joaquin River Resource Management Coalition (Chapter 3).

5.44 Susan Rusconi, R&S Farms

R & S Farms
PO Box 246
Cantua Creek, CA 93608
559-829-6030
559-829-6031 fax

DATE AFTER DECLASSIFICATION	
JUL - 2 2009	
170	✓

Mr. Jason Phillips
SJRRP Program Manager
U.S. Bureau of Reclamation
2800 Cottage Way, MP-170
Sacramento, CA 95825-1898

RE: Environmental Analysis for the San Joaquin River Restoration Program

Dear Mr. Phillips,

I am interested in the environmental review process for the above-referenced proceeding. Please include this letter and comments for the record in this environmental review process.

RUSCONI-1

I hereby join in the comments submitted by the San Joaquin River Resource Management Coalition (RMC). The purpose of this letter is to fulfill my obligation to exhaust administrative remedies. Whether or not I choose to raise all issues raised by the RMC or others will be determined at a later time.

Sincerely,

Susan Rusconi

Susan Rusconi
R & S Farms
PO Box 246
Cantua Creek, CA 93608
APN : 040-213-006-000
040-214-007-000

NOTICE: IF YOU DETACH
ENCLOSURE PLEASE INSERT
CODE NO. _____
INITIAL _____
DATE _____

Classification	Env-6.00
Project	214
Control No.	09038803
Folder I.D.	1019105
Date Input & initials	7-2-09 RCB

RUSCONI-2

**SURVEY REGARDING POTENTIAL IMPACTS OF SAN JOAQUIN RIVER
RESTORATION PROGRAM**

Please submit 1 survey for each property you own.

Name: R+S Farms
Address: PO Box 246
City: Pantua Creek CA 93608
Assessor's Parcel No(s): 040-213-006-000
040-214-007-000

Contact Information:
Telephone Number: 559 829-6030
Cell Phone Number: 559 304-7790
Email Address: qs farms 5@aol.com

Please provide responses to each of the following questions:

1. For each APN identified above, please specify the approximate distance from the river for each parcel.

APNs:	Distance from river:
<u>040-213-006-000</u>	<u>1/3 of a mile</u>
<u>040-214-007-000</u>	<u>50 ft to levee</u>

2. The current uses of the property described above are for:

☒ Annual crops
☐ Trees
☒ Vines
☐ Commercial
☐ Industrial
☐ Residential
☐ Governmental
☐ Wildlife refuge
☒ Other (please explain) Currently 115 acres on drip
on apr 040-213-006-000

3. Based upon your experience, if river flows are expected to range from approximately 475 cfs to 1300 cfs during the course of a year, what impacts are likely to be experienced on your property(s):

- ☒ High groundwater that saturates the root zone
- ☒ High groundwater that causes surface flooding
- ☒ Other seepage impacts impeding farming practices
- ☒ Flooding
- ☒ Increased levee maintenance requirements
- ☐ Increases to groundwater levels with no adverse impact to crops or surface conditions
- ☐ Loss of riparian zone
- ☐ Enhanced riparian zone

4. If you anticipate losing any real property as a result of the flow increases, please provide your best estimate as to the amount of property that will be lost and describe how the loss will occur.

a. Acreage lost: 115 acres-

b. Explanation:

The last time the river overflowed its banks, we were unable to farm some of the ground. The water level seeped through the levee and flooded about 115 acres.

We do have a drainage, and/or tiles that we can use to pump from, to water our crops when the river is running and want to continue that use.

We also use the San Mateo crossing to move equipment to our other location. This helps keep equipment off the state highways and roadways. We want to continue that use.

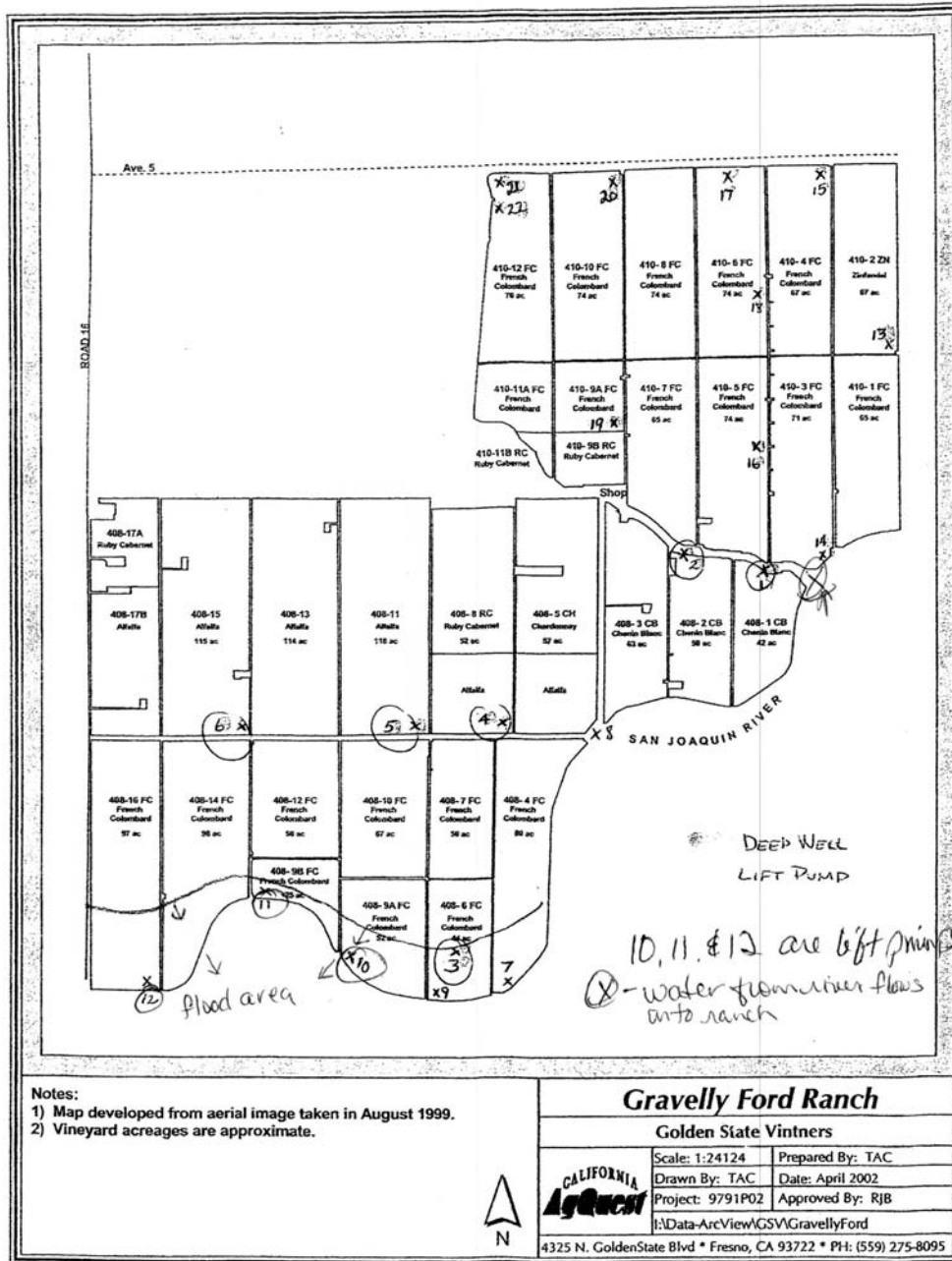

Responses to Comments from Susan Rusconi, R&S Farms

Rusconi-1, and -2: As described in Section 4.0 of the Draft Environmental Assessment/Initial Study (EA/IS), water levels are not anticipated to cause seepage through the levee and flood lands as a result of WY 2010 Interim Flows. See response to comment RMC-10.

San Mateo Road, at the San Joaquin River crossing, is a private road. Detour plans for private road crossings are not included in the Proposed Action.

5.45 John Satragni, Satragni Bros Ranch

Copy for stamping only

DRAFT LANDOWNER COMMENT LETTER TO BUREAU OF RECLAMATION 2 4 2009

[Date]
6/21/09

Mr. Jason Phillips
SJRRP Program Manager
U.S. Bureau of Reclamation
2800 Cottage Way, MP-170
Sacramento, CA 95825-1898
InterimFlows@restoresjr.net

RE: **Environmental Analysis for the San Joaquin River Restoration Program**

Dear Mr. Phillips:

I am interested in the environmental review process for the above-referenced proceeding. Please include this letter and comments for the record in this environmental review process.

SBR-1 I hereby join in the comments submitted by the San Joaquin River Resource Management Coalition (RMC). The purpose of this letter is to fulfill my obligation to exhaust administrative remedies. Whether or not I choose to raise all issues raised by the RMC or others will be determined at a later time.

Sincerely yours,

John Satragni

Name: SATRAGNI BROS RANCH
Address: 22000 W. SHIELDS AVE
City: KERMAN, CA 93630
Assessor's Parcel No(s): 015-070-345
015-030-215
015-030-225

CODE	ACTION	SURNAME & DATE
170	<input checked="" type="checkbox"/>	

Classification	<u>NV600</u>
Project	<u>214</u>
Control No	<u>89036962</u>
Folder No	<u>1019105</u>
Date Input & Initials	<u>6-21-09</u> <i>JS</i>

Responses to Comments from John Satragni, Satragni Bros Ranch

SBR-1: See responses to comments from the San Joaquin River Resource Management Coalition (Chapter 3).

5.46 Merwyn E. Schafer

DRAFT LANDOWNER COMMENT LETTER TO BUREAU OF RECLAMATION

[Date]

Mr. Jason Phillips
SJRRP Program Manager
U.S. Bureau of Reclamation
2800 Cottage Way, MP-170
Sacramento, CA 95825-1898
InterimFlows@restoresjr.net

BUREAU OF RECLAMATION
OFFICIAL FILE COPY
RECEIVED
JUL 07 2009

CODE	ACTION	SURNAME & DATE
170	<input checked="" type="checkbox"/>	

RE: **Environmental Analysis for the San Joaquin River Restoration Program**

Dear Mr. Phillips:

I am interested in the environmental review process for the above-referenced proceeding.
Please include this letter and comments for the record in this environmental review process.

SCHAFFER (A) - 1 I hereby join in the comments submitted by the San Joaquin River Resource Management Coalition (RMC). The purpose of this letter is to fulfill my obligation to exhaust administrative remedies. Whether or not I choose to raise all issues raised by the RMC or others will be determined at a later time.

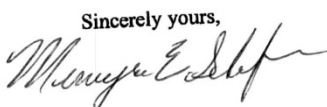
Sincerely yours,

Name: Merwyn Schafer
Address: 25176 Ave 5th
City: Madera CA 93637
Assessor's Parcel No(s): 040-131-005

Classification: ENV600
Project: 210
Control No.: 04039440
Folder ID: 1019105
Date Input & Initials: 7-2-09 

Columbia Canal Company
6770 Ave. 7 1/2
Firebaugh, CA 93622

Responses to Comments from Merwyn E. Schafer

Schafer (A)-1: See responses to comments from the San Joaquin River Resource Management Coalition (Chapter 3).

5.47 Michael Schafer

DRAFT LANDOWNER COMMENT LETTER TO BUREAU OF RECLAMATION

[Date]

Mr. Jason Phillips
SJRRP Program Manager
U.S. Bureau of Reclamation
2800 Cottage Way, MP-170
Sacramento, CA 95825-1898
InterimFlows@restoresjr.net

BUREAU OF RECLAMATION OFFICIAL FILE COPY RECEIVED	
JUL 07, 2009	
CODE	SUBNAME & DATE
190	

RE: *Environmental Analysis for the San Joaquin River Restoration Program*

Dear Mr. Phillips:

I am interested in the environmental review process for the above-referenced proceeding. Please include this letter and comments for the record in this environmental review process.

SCHAFFER (B) -1 I hereby join in the comments submitted by the San Joaquin River Resource Management Coalition (RMC). The purpose of this letter is to fulfill my obligation to exhaust administrative remedies. Whether or not I choose to raise all issues raised by the RMC or others will be determined at a later time.

Sincerely yours,

Michael Schafer

Name:
Address:
City:
Assessor's Parcel No(s):

Mike Schafer
4614 Rd 24 E
Madera CA 93637
040-182-002
040-182-003

Application	ENR 600
Project	214
Contract No.	09039443
Project ID	1019/05
Date input & initials	7-5-09 <i>SP</i>

Columbia Canal Company
6770 Ave. 7 1/2
Firebaugh, CA 93622

Responses to Comments from Michael Schafer

Schafer (B)-1: See responses to comments from the San Joaquin River Resource Management Coalition (Chapter 3).

5.48 Joe and Sharon Sequeira

DRAFT LANDOWNER COMMENT LETTER TO BUREAU OF RECLAMATION

[Date] 6/15/09

Mr. Jason Phillips
SJRRP Program Manager
U.S. Bureau of Reclamation
2800 Cottage Way, MP-170
Sacramento, CA 95825-1898
InterimFlows@restoresjr.net

RE: *Environmental Analysis for the San Joaquin River Restoration Program*

Dear Mr. Phillips:

I am interested in the environmental review process for the above-referenced proceeding. Please include this letter and comments for the record in this environmental review process.

SEQUEIRA-1

I hereby join in the comments submitted by the San Joaquin River Resource Management Coalition (RMC). The purpose of this letter is to fulfill my obligation to exhaust administrative remedies. Whether or not I choose to raise all issues raised by the RMC or others will be determined at a later time.

Sincerely yours,

Joe Sequeira
Sharon Sequeira

Name:

Address:

City:

Assessor's Parcel No(s):

Joe & Sharon Sequeira
15490 Welling Rd
Boss, CA 93620
85-020-09
85-010-07
85-020-07
85-090-45
85-090-08
85-090-54

Scanned 6/22/09 rfb

SEQUEIRA-2

**SURVEY REGARDING POTENTIAL IMPACTS OF SAN JOAQUIN RIVER
RESTORATION PROGRAM**

Please submit 1 survey for each property you own.

Name:
Address:
City:
Assessor's Parcel No(s):

Joe & Sharon Sequeira
15490 Willis Rd
Dubuque, Ca 93620

Contact Information:

Telephone Number:
Cell Phone Number:
Email Address:

209-387-4371
209-675-0927
vava.sharon@yahoo.com

Please provide responses to each of the following questions:

1. For each APN identified above, please specify the approximate distance from the river for each parcel.

APNs:

Distance from river:

<u>85-020-09</u>	<u>60 ft.</u>
<u>85-010-07</u>	<u>60 ft.</u>
<u>85-020-07</u>	<u>60 ft.</u>

2. The current uses of the property described above are for:

☒ Annual crops
☐ Trees
☐ Vines
☐ Commercial
☐ Industrial
☐ Residential
☐ Governmental
☐ Wildlife refuge
☐ Other (please explain)

85-090-45 - 1/4 mile
85-040-08 - 1/4 mile
85-090-54 - 1/4 mile

3. Based upon your experience, if river flows are expected to range from approximately 475 cfs to 1300 cfs during the course of a year, what impacts are likely to be experienced on your property(s):

- ☒ High groundwater that saturates the root zone
- ☐ High groundwater that causes surface flooding
- ☒ Other seepage impacts impeding farming practices
- ☒ Flooding
- ☒ Increased levee maintenance requirements
- ☐ Increases to groundwater levels with no adverse impact to crops or surface conditions
- ☒ Loss of riparian zone
- ☐ Enhanced riparian zone

4. If you anticipate losing any real property as a result of the flow increases, please provide your best estimate as to the amount of property that will be lost and describe how the loss will occur.

a. Acreage lost: *250 AC est.*

b. Explanation: *Water seepage would not allow us to plant a crop that could sustain the root zone saturation and the fields would not be accessible because of too much moisture for our equipment.*

Responses to Comments from Joe and Sharon Sequeira

Sequeira-1, and -2: See responses to comments from the San Joaquin River Resource Management Coalition (Chapter 3).

5.49 Ken Samarin, Samarin Farms

DRAFT LANDOWNER COMMENT LETTER TO BUREAU OF RECLAMATION

[Date] 6-25-09

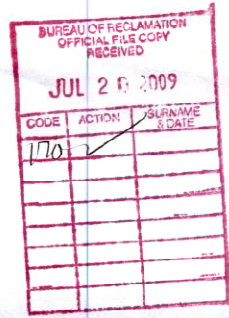

Mr. Jason Phillips
SJRRP Program Manager
U.S. Bureau of Reclamation
2800 Cottage Way, MP-170
Sacramento, CA 95825-1898
InterimFlows@restoresjr.net

RE: *Environmental Analysis for the San Joaquin River Restoration Program*

Dear Mr. Phillips:

I am interested in the environmental review process for the above-referenced proceeding. Please include this letter and comments for the record in this environmental review process.

SF-1 I hereby join in the comments submitted by the San Joaquin River Resource Management Coalition (RMC). The purpose of this letter is to fulfill my obligation to exhaust administrative remedies. Whether or not I choose to raise all issues raised by the RMC or others will be determined at a later time.

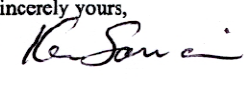
Sincerely yours,

Name: Samarin Farms
Address: Ken Samarin
City: 2085 N Lake
Assessor's Parcel No(s): Kerman CA 93630
012-040-045
042-010-043
042-061-006
042-100-008
042-100-003
042-150-001
042-150-002
042-150-004
042-161-002

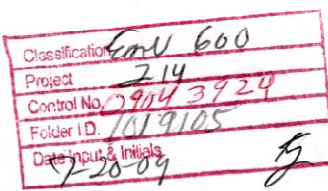

Responses to Comments from Ken Samarin, Samarin Farms

SF-1: See responses to comments from the San Joaquin River Resource Management Coalition (Chapter 3).

5.50 Cynthia Nicolette, Santa Rita Farms

<p style="text-align: center;">SANTA RITA FARMS 16032 Indiana Road Dos Palos, CA 93620</p> <p>June 29, 2009</p> <p>Mr. Jason Phillips SJRRP Program Manager U.S. Bureau of Reclamation 2800 Cottage Way, MP-170 Sacramento, CA 95825-1898 InterimFlows@restoresjr.net</p> <p>Re: Environmental Analysis for the San Joaquin River Restoration Program</p> <p>Dear Mr. Phillips</p> <p>I am interested in the environmental review process for the above-referenced proceedings. Please include this letter and comments for the record in this environmental review process.</p> <p>SRF-1 I hereby join in the comments submitted by the San Joaquin River Resource Management Coalition (RMC). The purpose of this letter is to fulfill my obligation to exhaust administrative remedies. Whether or not to choose to raise all issues raised by the RMC or others will be determined at a later time.</p> <p>Sincerely yours,</p> <p style="text-align: center;"><i>Christina-Santa Rita Farms by Cynthia Nicolette</i></p> <p>Santa Rita Farms 16032 Indiana Road Dos Palos, CA 93620</p> <p>Assessor's Parcel No(s): Attached</p>	<table border="1" style="width: 100%;"><tr><td colspan="3" style="text-align: center;">BUREAU OF RECLAMATION OFFICIAL FILE COPY RECEIVED</td></tr><tr><td colspan="3" style="text-align: center;">JUL 07 2009</td></tr><tr><td>CODE</td><td>ACTION</td><td>DATE</td></tr><tr><td>170</td><td>✓</td><td></td></tr><tr><td> </td><td> </td><td> </td></tr><tr><td> </td><td> </td><td> </td></tr><tr><td> </td><td> </td><td> </td></tr><tr><td> </td><td> </td><td> </td></tr><tr><td> </td><td> </td><td> </td></tr><tr><td> </td><td> </td><td> </td></tr><tr><td> </td><td> </td><td> </td></tr><tr><td> </td><td> </td><td> </td></tr></table> <table border="1" style="width: 100%;"><tr><td colspan="2" style="text-align: center;">NOTICE: IF YOU OPEN ENCLOSURE PLEASE INITIAL</td></tr><tr><td>CODE NO:</td><td> </td></tr><tr><td>INITIAL:</td><td> </td></tr><tr><td>DATE:</td><td> </td></tr></table> <table border="1" style="width: 100%;"><tr><td>Classification</td><td>ENV 600</td></tr><tr><td>Project</td><td>214</td></tr><tr><td>Control No.</td><td>09039384</td></tr><tr><td>Folder ID</td><td>1019105</td></tr><tr><td>Date Input</td><td>7-7-09</td></tr></table>	BUREAU OF RECLAMATION OFFICIAL FILE COPY RECEIVED			JUL 07 2009			CODE	ACTION	DATE	170	✓																										NOTICE: IF YOU OPEN ENCLOSURE PLEASE INITIAL		CODE NO:		INITIAL:		DATE:		Classification	ENV 600	Project	214	Control No.	09039384	Folder ID	1019105	Date Input	7-7-09
BUREAU OF RECLAMATION OFFICIAL FILE COPY RECEIVED																																																							
JUL 07 2009																																																							
CODE	ACTION	DATE																																																					
170	✓																																																						
NOTICE: IF YOU OPEN ENCLOSURE PLEASE INITIAL																																																							
CODE NO:																																																							
INITIAL:																																																							
DATE:																																																							
Classification	ENV 600																																																						
Project	214																																																						
Control No.	09039384																																																						
Folder ID	1019105																																																						
Date Input	7-7-09																																																						

San Joaquin River Restoration Program

APN	OWNER	GISACRES
85070026	BAKER CAROLYN C CO-TRUSTEE	34.8
85070026	BAKER CAROLYN C CO-TRUSTEE	3.62
85140008	MARTINELLI ARGENTINA	100.49
85140009	BAKER CAROLYN C CO-TRUSTEE	417.09
85140009	BAKER CAROLYN C CO-TRUSTEE	90.31
85150001	BAKER CAROLYN C CO-TRUSTEE	59.6
85150003	BAKER CAROLYN C CO-TRUSTEE	68.22
85160001	BAKER CAROLYN C CO-TRUSTEE	145.93
85160003	BAKER CAROLYN C CO-TRUSTEE	108.28
85160008	BAKER CAROLYN C CO-TRUSTEE	13.23
85170011	MARTINELLI ARGENTINA	37.67
85170025	MARTINELLI ARGENTINA	15.29
85170032	BAKER CAROLYN C CO-TRUSTEE	42.65
85230024	BAKER CAROLYN C CO-TRUSTEE	9.55
85230034	BAKER CAROLYN C CO-TRUSTEE	34.31
85230038	NICOLETTI JOHN A & CYNTHIA TRUSTEES	1.17
85230039	BAKER CAROLYN C CO-TRUSTEE	197.29
85330021	MARTINELLI ARGENTINA	41.61
85330030	BRADAC EVA M TRUSTEE	79.76
85350017	MARTINELLI ARGENTINA	21.81
85360006	BRADAC EVA M,TRUSTEE	45.5
85360008	MARTINELLI ARGENTINA	102.39
85360013	BAKER CAROLYN C CO-TRUSTEE	38.02
85360035	BAKER CAROLYN C CO-TRUSTEE	138.34
85360035	BAKER CAROLYN C CO-TRUSTEE	8.64
85360035	BAKER CAROLYN C CO-TRUSTEE	2.02
85360039	BAKER CAROLYN C CO-TRUSTEE	263.17
		2120.76

Responses to Comments from Cynthia Nicolette, Santa Rita Farms

SRF-1: See responses to comments from the San Joaquin River Resource Management Coalition (Chapter 3).

5.51 Michael Vander Dussen

BUREAU OF RECLAMATION OFFICE JUN	
DRAFT LANDOWNER COMMENT LETTER TO BUREAU OF RECLAMATION	
[Date] 6-12-09	MP 170 ✓
Mr. Jason Phillips SJRRP Program Manager U.S. Bureau of Reclamation 2800 Cottage Way, MP-170 Sacramento, CA 95825-1898 InterimFlows@restoresjr.net	
RE: <i>Environmental Analysis for the San Joaquin River Restoration Program</i>	
Dear Mr. Phillips:	
I am interested in the environmental review process for the above-referenced proceeding. Please include this letter and comments for the record in this environmental review process.	
VANDERDUSSEN-1	I hereby join in the comments submitted by the San Joaquin River Resource Management Coalition (RMC). The purpose of this letter is to fulfill my obligation to exhaust administrative remedies. Whether or not I choose to raise all issues raised by the RMC or others will be determined at a later time.
Sincerely yours,	
Name:	Michael Vander Dussen
Address:	729 East Jefferson Rd
City:	El Nido CA 95317
Assessor's Parcel No(s):	074-040-028 074-070-012 074-130-029
Classification	ENV-7600
Project	214
Control No.	07035123
Folder I.D.	1082648
Date Input & Initials	6/15/2009

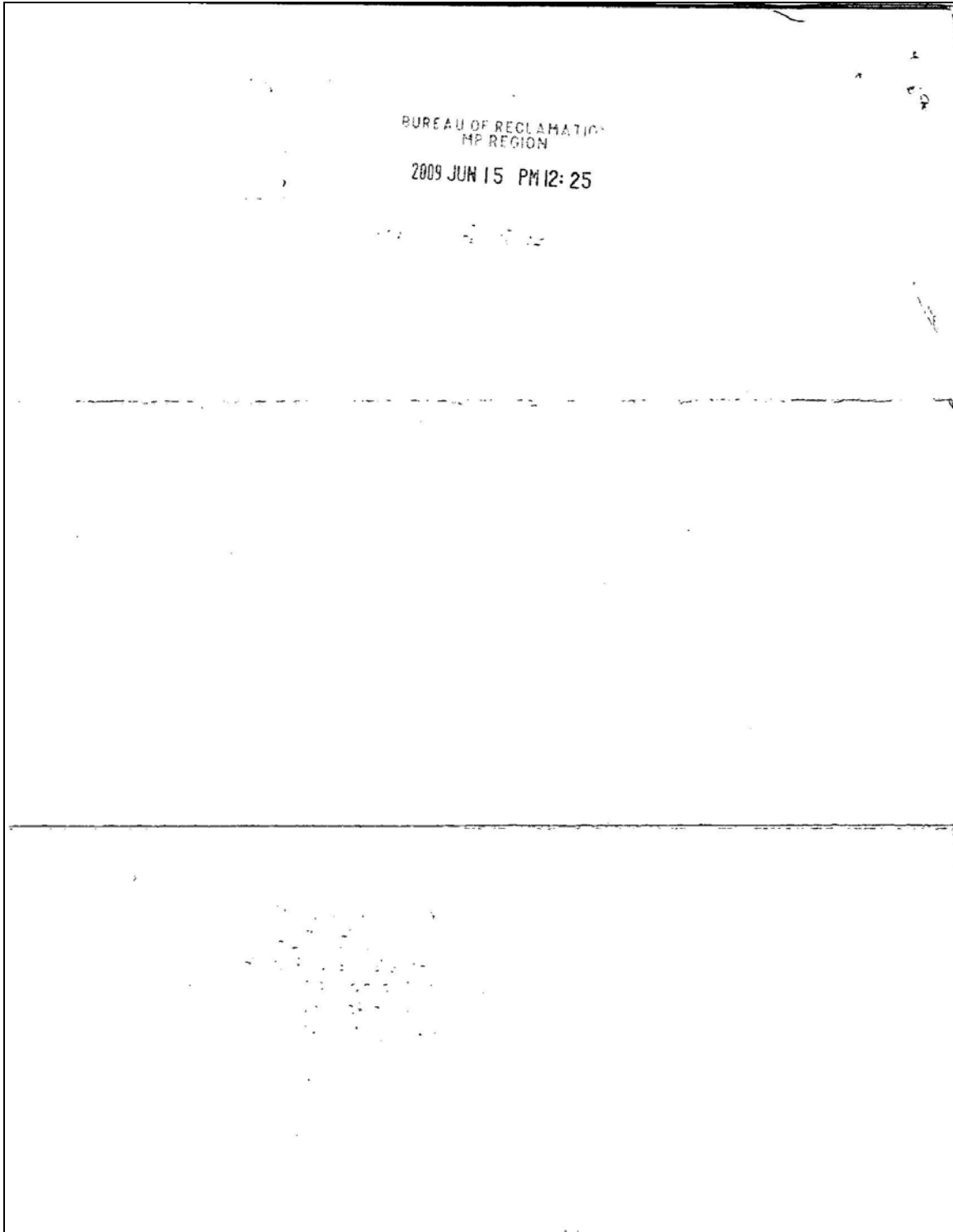

VANDERDUSSEN-2

**SURVEY REGARDING POTENTIAL IMPACTS OF SAN JOAQUIN RIVER
RESTORATION PROGRAM**

Please submit 1 survey for each property you own.

Name: Michael VanderDussen
Address: 729 East Jefferson Rd
City: El Nido CA 95317
Assessor's Parcel No(s): 074-060-028
074-070-012
074-130-029

Contact Information:

Telephone Number: 209 726.1243
Cell Phone Number: 209 564 2000
Email Address: MVANDERDUS@AOL.COM

Please provide responses to each of the following questions:

1. For each APN identified above, please specify the approximate distance from the river for each parcel.

APNs:	Distance from river:
<u>074-060-028</u>	<u>4000 ft</u>
<u>074-070-012</u>	<u>0-200 ft</u>
<u>074-130-029</u>	<u>0-200 ft</u>

2. The current uses of the property described above are for:

☒ Annual crops
☐ Trees
☐ Vines
☐ Commercial
☐ Industrial
☐ Residential
☐ Governmental
☐ Wildlife refuge
☐ Other (please explain)

3. Based upon your experience, if river flows are expected to range from approximately 475 cfs to 1300 cfs during the course of a year, what impacts are likely to be experienced on your property(s):

- ☒ High groundwater that saturates the root zone
- ☐ High groundwater that causes surface flooding
- ☒ Other seepage impacts impeding farming practices
- ☐ Flooding
- ☐ Increased levee maintenance requirements
- ☐ Increases to groundwater levels with no adverse impact to crops or surface conditions
- ☐ Loss of riparian zone
- ☐ Enhanced riparian zone

4. If you anticipate losing any real property as a result of the flow increases, please provide your best estimate as to the amount of property that will be lost and describe how the loss will occur.

- a. Acreage lost: *30 Acres*
- b. Explanation: *Any additional expansion of existing levee banks or additional setbacks would take away productive farmland.*

Responses to Comments from Michael Vander Dussen

VanderDussen-1, and -2: See responses to comments from the San Joaquin River Resource Management Coalition (Chapter 3).

5.52 George Wagner

DRAFT LANDOWNER COMMENT LETTER TO BUREAU OF RECLAMATION

[Date]

Mr. Jason Phillips
SJRRP Program Manager
U.S. Bureau of Reclamation
2800 Cottage Way, MP-170
Sacramento, CA 95825-1898
InterimFlows@restoresjr.net

RE: ***Environmental Analysis for the San Joaquin River Restoration Program***

Dear Mr. Phillips:

I am interested in the environmental review process for the above-referenced proceeding. Please include this letter and comments for the record in this environmental review process.

WAGNER - 1 I hereby join in the comments submitted by the San Joaquin River Resource Management Coalition (RMC). The purpose of this letter is to fulfill my obligation to exhaust administrative remedies. Whether or not I choose to raise all issues raised by the RMC or others will be determined at a later time.

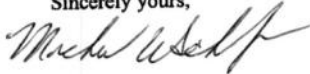
Sincerely yours,

Name: George Wagner
Address: 25176 Ave 5th
City: Merced CA 93637
Assessor's Parcel No(s): 040-131-009
040-131-007
040-132-023
040-132-027

Columbia Canal Company
6770 Ave. 7th
Firebaugh, CA 93622

5

BUREAU OF RECLAMATION OFFICIAL FILE COPY RECEIVED		
CODE	ACTION	SUPPLEMENT DATE
170	✓	MC 7/25/09

Project	EN 600
Contract No.	09039457
Expend ID	1019705
Order No.	9-202

Responses to Comments from George Wagner

Wagner-1: See responses to comments from the San Joaquin River Resource Management Coalition (Chapter 3).

5.53 Michael Willis, 4-W Ranch

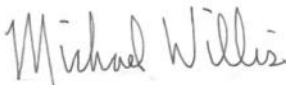
4-W RANCH 12593 Elgin Ave. Dos Palos, CA 93620		<div>BUREAU OF RECLAMATION OFFICIAL FILE COPY JUL 02 2009</div> <table border="1"><thead><tr><th>DATE</th><th>ACTION</th><th>SIGNATURE</th></tr></thead><tbody><tr><td>MP17P</td><td>✓</td><td></td></tr><tr><td> </td><td> </td><td> </td></tr><tr><td> </td><td> </td><td> </td></tr><tr><td> </td><td> </td><td> </td></tr><tr><td> </td><td> </td><td> </td></tr><tr><td> </td><td> </td><td> </td></tr><tr><td> </td><td> </td><td> </td></tr><tr><td> </td><td> </td><td> </td></tr><tr><td> </td><td> </td><td> </td></tr></tbody></table>	DATE	ACTION	SIGNATURE	MP17P	✓																									
DATE	ACTION	SIGNATURE																														
MP17P	✓																															
<p>June 29, 2009</p>																																
<p>Mr. Jason Phillips SJRRP Program Manager U.S. Bureau of Reclamation 2800 Cottage Way, MP-170 Sacramento, CA 95825-1898 InterimFlows@restoresjr.net</p>																																
<p>Re: Environmental Analysis for the San Joaquin River Restoration Program</p>																																
<p>Dear Mr. Phillips</p>																																
<p>I am interested in the environmental review process for the above-referenced proceedings. Please include this letter and comments for the record in this environmental review process.</p>																																
WILLIS-1	<p>I hereby join in the comments submitted by the San Joaquin River Resource Management Coalition (RMC). The purpose of this letter is to fulfill my obligation to exhaust administrative remedies. Whether or not to choose to raise all issues raised by the RMC or others will be determined at a later time.</p>																															
<p>Sincerely yours,</p>																																
																																
<p>Michael Willis Land Owner</p>																																
<p>Michael Willis 12593 Elgin Ave. Dos Palos, CA 93620</p>																																
<p>Assessor's Parcel No(s): Attached</p>																																
<div>San Luis Canal Company 11704 W. Henry Miller Avenue • Dos Palos, CA 93620</div>																																
		<table border="1"><tr><td>Classification</td><td>ENV-7.00</td></tr><tr><td>Project</td><td>214</td></tr><tr><td>Control No.</td><td>01038608</td></tr><tr><td>Folder ID</td><td>1082644</td></tr><tr><td>Date Printed / Initials</td><td>7/2/2009 JH</td></tr></table>	Classification	ENV-7.00	Project	214	Control No.	01038608	Folder ID	1082644	Date Printed / Initials	7/2/2009 JH																				
Classification	ENV-7.00																															
Project	214																															
Control No.	01038608																															
Folder ID	1082644																															
Date Printed / Initials	7/2/2009 JH																															

5

San Joaquin River Restoration Program

APN	OWNER	GISACRES
73390019	WILLIS HERMAN C	450.55
73170008	WILLIS HERMAN MICHAEL	312.58
73170008	WILLIS HERMAN MICHAEL	9.34
73390009	WILLIS WENDY	13.89
85280014	WILLIS WENDY	21.76

Responses to Comments from Michael Willis, 4-W Ranch

Willis-1: See responses to comments from the San Joaquin River Resource Management Coalition (Chapter 3).

This page left blank intentionally.