

**Ric Windmiller**  
CONSULTING ARCHAEOLOGIST

2280 GRASS VALLEY HIGHWAY #205  
AUBURN, CALIFORNIA 95603

530/878-0979  
FAX 530/878-0915

August 12, 2011

Mr. Dennis E. Ramirez  
Chairperson  
Mechoopda Indian Tribe of Chico Rancheria  
125 Mission Ranch Blvd.  
Chico, CA 95926

Re: Gray Lodge Water Supply Project, Butte County

Dear Mr. Ramirez:

Our consultancy is conducting a cultural resources study of approximately 20 miles of existing water canals and canal structures in Butte County. The Gray Lodge Water Supply Project is designed to bring increased water flow to the Gray Lodge Wildlife Area by way of the Biggs-West Gridley Water District's delivery system. The Gray Lodge Wildlife Area is located 65 miles north of Sacramento, California (please see enclosed map).

The Native American Heritage Commission's sacred lands file search failed to identify any Native American cultural resources. A records search by the Northeast Information Center and field inspection by a qualified archaeologist are underway. However, we are aware that a proposed project may affect sites of religious or sacred significance to Native Americans that may not be recognized by non-Native American archaeologists. Therefore, if you have any information or concerns regarding known or suspected sites of Native American significance that may be impacted by the proposed project, please feel free to contact Cathryn Chatterton at the above address. You may also respond by telephone (530-878-0979), fax (530-878-0915) or email: [windmiller-consult@sbcglobal.net](mailto:windmiller-consult@sbcglobal.net). We would appreciate a response at your earliest convenience, if you wish to comment at this time.

Yours sincerely,

Ric Windmiller  
Registered Professional Archaeologist

Enclosure

**Ric Windmiller**  
CONSULTING ARCHAEOLOGIST

2280 GRASS VALLEY HIGHWAY #205  
AUBURN, CALIFORNIA 95603

530/878-0979  
FAX 530/878-0915

August 12, 2011

Mr. Kyle Self  
Chairperson  
Greenville Rancheria of Maidu Indians  
P. Box Box 279  
Greenville, CA 95947

Re: Gray Lodge Water Supply Project, Butte County

Dear Mr. Self:

Our consultancy is conducting a cultural resources study of approximately 20 miles of existing water canals and canal structures in Butte County. The Gray Lodge Water Supply Project is designed to bring increased water flow to the Gray Lodge Wildlife Area by way of the Biggs-West Gridley Water District's delivery system. The Gray Lodge Wildlife Area is located 65 miles north of Sacramento, California (please see enclosed map).

The Native American Heritage Commission's sacred lands file search failed to identify any Native American cultural resources. A records search by the Northeast Information Center and field inspection by a qualified archaeologist are underway. However, we are aware that a proposed project may affect sites of religious or sacred significance to Native Americans that may not be recognized by non-Native American archaeologists. Therefore, if you have any information or concerns regarding known or suspected sites of Native American significance that may be impacted by the proposed project, please feel free to contact Cathryn Chatterton at the above address. You may also respond by telephone (530-878-0979), fax (530-878-0915) or email: [windmiller-consult@sbcglobal.net](mailto:windmiller-consult@sbcglobal.net). We would appreciate a response at your earliest convenience, if you wish to comment at this time.

Yours sincerely,

Ric Windmiller  
Registered Professional Archaeologist

Enclosure

**Ric Windmiller**  
CONSULTING ARCHAEOLOGIST

2280 GRASS VALLEY HIGHWAY #205  
AUBURN, CALIFORNIA 95603

530/878-0979  
FAX 530/878-0915

August 12, 2011

Ms. Clara LeCompte  
Maidu Nation  
P.O. Box 204  
Susanville, CA 96130

Re: Gray Lodge Water Supply Project, Butte County

Dear Ms. LeCompte:

Our consultancy is conducting a cultural resources study of approximately 20 miles of existing water canals and canal structures in Butte County. The Gray Lodge Water Supply Project is designed to bring increased water flow to the Gray Lodge Wildlife Area by way of the Biggs-West Gridley Water District's delivery system. The Gray Lodge Wildlife Area is located 65 miles north of Sacramento, California (please see enclosed map).

The Native American Heritage Commission's sacred lands file search failed to identify any Native American cultural resources. A records search by the Northeast Information Center and field inspection by a qualified archaeologist are underway. However, we are aware that a proposed project may affect sites of religious or sacred significance to Native Americans that may not be recognized by non-Native American archaeologists. Therefore, if you have any information or concerns regarding known or suspected sites of Native American significance that may be impacted by the proposed project, please feel free to contact Cathryn Chatterton at the above address. You may also respond by telephone (530-878-0979), fax (530-878-0915) or email: [windmiller-consult@sbcglobal.net](mailto:windmiller-consult@sbcglobal.net). We would appreciate a response at your earliest convenience, if you wish to comment at this time.

Yours sincerely,

Ric Windmiller  
Registered Professional Archaeologist

Enclosure



**Ric Windmiller**  
CONSULTING ARCHAEOLOGIST

2280 GRASS VALLEY HIGHWAY #205  
AUBURN, CALIFORNIA 95603

530/878-0979  
FAX 530/878-0915

August 12, 2011

Mr. Ren Reynolds  
Butte Tribal Council  
1693 Mt. Ida Road  
Oroville, CA 95966

Re: Gray Lodge Water Supply Project, Butte County

Dear Mr. Reynolds:

Our consultancy is conducting a cultural resources study of approximately 20 miles of existing water canals and canal structures in Butte County. The Gray Lodge Water Supply Project is designed to bring increased water flow to the Gray Lodge Wildlife Area by way of the Biggs-West Gridley Water District's delivery system. The Gray Lodge Wildlife Area is located 65 miles north of Sacramento, California (please see enclosed map).

The Native American Heritage Commission's sacred lands file search failed to identify any Native American cultural resources. A records search by the Northeast Information Center and field inspection by a qualified archaeologist are underway. However, we are aware that a proposed project may affect sites of religious or sacred significance to Native Americans that may not be recognized by non-Native American archaeologists. Therefore, if you have any information or concerns regarding known or suspected sites of Native American significance that may be impacted by the proposed project, please feel free to contact Cathryn Chatterton at the above address. You may also respond by telephone (530-878-0979), fax (530-878-0915) or email: [windmiller-consult@sbcglobal.net](mailto:windmiller-consult@sbcglobal.net). We would appreciate a response at your earliest convenience, if you wish to comment at this time.

Yours sincerely,

Ric Windmiller  
Registered Professional Archaeologist

Enclosure

**Ric Windmiller**  
CONSULTING ARCHAEOLOGIST

2280 GRASS VALLEY HIGHWAY #205  
AUBURN, CALIFORNIA 95603

530/878-0979  
FAX 530/878-0915

August 12, 2011

Mr. Gary Archuleta  
Chairperson  
Mooretown Rancheria of Maidu Indians  
#1 Alverda Drive  
Oroville, CA 95966

Re: Gray Lodge Water Supply Project, Butte County

Dear Mr. Archuleta:

Our consultancy is conducting a cultural resources study of approximately 20 miles of existing water canals and canal structures in Butte County. The Gray Lodge Water Supply Project is designed to bring increased water flow to the Gray Lodge Wildlife Area by way of the Biggs-West Gridley Water District's delivery system. The Gray Lodge Wildlife Area is located 65 miles north of Sacramento, California (please see enclosed map).

The Native American Heritage Commission's sacred lands file search failed to identify any Native American cultural resources. A records search by the Northeast Information Center and field inspection by a qualified archaeologist are underway. However, we are aware that a proposed project may affect sites of religious or sacred significance to Native Americans that may not be recognized by non-Native American archaeologists. Therefore, if you have any information or concerns regarding known or suspected sites of Native American significance that may be impacted by the proposed project, please feel free to contact Cathryn Chatterton at the above address. You may also respond by telephone (530-878-0979), fax (530-878-0915) or email: [windmiller-consult@sbcglobal.net](mailto:windmiller-consult@sbcglobal.net). We would appreciate a response at your earliest convenience, if you wish to comment at this time.

Yours sincerely,

Ric Windmiller  
Registered Professional Archaeologist

Enclosure

**Ric Windmiller**  
CONSULTING ARCHAEOLOGIST

2280 GRASS VALLEY HIGHWAY #205  
AUBURN, CALIFORNIA 95603

530/878-0979  
FAX 530/878-0915

August 12, 2011

Ms. Lorena Gorbet  
Maidu Cultural and Development Group  
P.O. Box 426  
Greenville, CA 95947

Re: Gray Lodge Water Supply Project, Butte County

Dear Ms. Gorbet:

Our consultancy is conducting a cultural resources study of approximately 20 miles of existing water canals and canal structures in Butte County. The Gray Lodge Water Supply Project is designed to bring increased water flow to the Gray Lodge Wildlife Area by way of the Biggs-West Gridley Water District's delivery system. The Gray Lodge Wildlife Area is located 65 miles north of Sacramento, California (please see enclosed map).

The Native American Heritage Commission's sacred lands file search failed to identify any Native American cultural resources. A records search by the Northeast Information Center and field inspection by a qualified archaeologist are underway. However, we are aware that a proposed project may affect sites of religious or sacred significance to Native Americans that may not be recognized by non-Native American archaeologists. Therefore, if you have any information or concerns regarding known or suspected sites of Native American significance that may be impacted by the proposed project, please feel free to contact Cathryn Chatterton at the above address. You may also respond by telephone (530-878-0979), fax (530-878-0915) or email: [windmiller-consult@sbcglobal.net](mailto:windmiller-consult@sbcglobal.net). We would appreciate a response at your earliest convenience, if you wish to comment at this time.

Yours sincerely,

Ric Windmiller  
Registered Professional Archaeologist

Enclosure



**Ric Windmiller**  
CONSULTING ARCHAEOLOGIST

2280 GRASS VALLEY HIGHWAY #205  
AUBURN, CALIFORNIA 95603

530/878-0979  
FAX 530/878-0915

August 12, 2011

Ms. Patsy Seek  
Chairperson  
KonKow Valley Band of Maidu  
1706 Sweem Street  
Oroville, CA 95965

Re: Gray Lodge Water Supply Project, Butte County

Dear Ms. Seek:

Our consultancy is conducting a cultural resources study of approximately 20 miles of existing water canals and canal structures in Butte County. The Gray Lodge Water Supply Project is designed to bring increased water flow to the Gray Lodge Wildlife Area by way of the Biggs-West Gridley Water District's delivery system. The Gray Lodge Wildlife Area is located 65 miles north of Sacramento, California (please see enclosed map).

The Native American Heritage Commission's sacred lands file search failed to identify any Native American cultural resources. A records search by the Northeast Information Center and field inspection by a qualified archaeologist are underway. However, we are aware that a proposed project may affect sites of religious or sacred significance to Native Americans that may not be recognized by non-Native American archaeologists. Therefore, if you have any information or concerns regarding known or suspected sites of Native American significance that may be impacted by the proposed project, please feel free to contact Cathryn Chatterton at the above address. You may also respond by telephone (530-878-0979), fax (530-878-0915) or email: [windmiller-consult@sbcglobal.net](mailto:windmiller-consult@sbcglobal.net). We would appreciate a response at your earliest convenience, if you wish to comment at this time.

Yours sincerely,

Ric Windmiller  
Registered Professional Archaeologist

Enclosure

**Ric Windmiller**  
CONSULTING ARCHAEOLOGIST

2280 GRASS VALLEY HIGHWAY #205  
AUBURN, CALIFORNIA 95603

530/878-0979  
FAX 530/878-0915

August 12, 2011  
Address corrected 9/21/2011

Ms. Eileen Moon  
Vice Chairperson  
Tsi-Akim Maidu  
1239 East Main Street  
Grass Valley, CA 95945

Re: Gray Lodge Water Supply Project, Butte County

Dear Ms. Moon:

Our consultancy is conducting a cultural resources study of approximately 20 miles of existing water canals and canal structures in Butte County. The Gray Lodge Water Supply Project is designed to bring increased water flow to the Gray Lodge Wildlife Area by way of the Biggs-West Gridley Water District's delivery system. The Gray Lodge Wildlife Area is located 65 miles north of Sacramento, California (please see enclosed map).

The Native American Heritage Commission's sacred lands file search failed to identify any Native American cultural resources. A records search by the Northeast Information Center and field inspection by a qualified archaeologist are underway. However, we are aware that a proposed project may affect sites of religious or sacred significance to Native Americans that may not be recognized by non-Native American archaeologists. Therefore, if you have any information or concerns regarding known or suspected sites of Native American significance that may be impacted by the proposed project, please feel free to contact Cathryn Chatterton at the above address. You may also respond by telephone (530-878-0979), fax (530-878-0915) or email: [windmiller-consult@sbcglobal.net](mailto:windmiller-consult@sbcglobal.net). We would appreciate a response at your earliest convenience, if you wish to comment at this time.

Yours sincerely,

Ric Windmiller  
Registered Professional Archaeologist

Enclosure



**Ric Windmiller**  
CONSULTING ARCHAEOLOGIST

2280 GRASS VALLEY HIGHWAY #205  
AUBURN, CALIFORNIA 95603

530/878-0979  
FAX 530/878-0915

August 12, 2011

Mr. James Sanders  
Tribal Administrator  
Mooretown Rancheria of Maidu Indians  
#1 Alverda Drive  
Oroville, CA 95966

Re: Gray Lodge Water Supply Project, Butte County

Dear Mr. Sanders:

Our consultancy is conducting a cultural resources study of approximately 20 miles of existing water canals and canal structures in Butte County. The Gray Lodge Water Supply Project is designed to bring increased water flow to the Gray Lodge Wildlife Area by way of the Biggs-West Gridley Water District's delivery system. The Gray Lodge Wildlife Area is located 65 miles north of Sacramento, California (please see enclosed map).

The Native American Heritage Commission's sacred lands file search failed to identify any Native American cultural resources. A records search by the Northeast Information Center and field inspection by a qualified archaeologist are underway. However, we are aware that a proposed project may affect sites of religious or sacred significance to Native Americans that may not be recognized by non-Native American archaeologists. Therefore, if you have any information or concerns regarding known or suspected sites of Native American significance that may be impacted by the proposed project, please feel free to contact Cathryn Chatterton at the above address. You may also respond by telephone (530-878-0979), fax (530-878-0915) or email: [windmiller-consult@sbcglobal.net](mailto:windmiller-consult@sbcglobal.net). We would appreciate a response at your earliest convenience, if you wish to comment at this time.

Yours sincerely,

Ric Windmiller  
Registered Professional Archaeologist

Enclosure

**Ric Windmiller**  
CONSULTING ARCHAEOLOGIST

2280 GRASS VALLEY HIGHWAY #205  
AUBURN, CALIFORNIA 95603

530/878-0979  
FAX 530/878-0915

August 12, 2011

Mr. Jim Edwards  
Chairperson  
Berry Creek Rancheria of Maidu Indians  
#5 Tyme Way  
Oroville, CA 95966

Re: Gray Lodge Water Supply Project, Butte County

Dear Mr. Edwards:

Our consultancy is conducting a cultural resources study of approximately 20 miles of existing water canals and canal structures in Butte County. The Gray Lodge Water Supply Project is designed to bring increased water flow to the Gray Lodge Wildlife Area by way of the Biggs-West Gridley Water District's delivery system. The Gray Lodge Wildlife Area is located 65 miles north of Sacramento, California (please see enclosed map).

The Native American Heritage Commission's sacred lands file search failed to identify any Native American cultural resources. A records search by the Northeast Information Center and field inspection by a qualified archaeologist are underway. However, we are aware that a proposed project may affect sites of religious or sacred significance to Native Americans that may not be recognized by non-Native American archaeologists. Therefore, if you have any information or concerns regarding known or suspected sites of Native American significance that may be impacted by the proposed project, please feel free to contact Cathryn Chatterton at the above address. You may also respond by telephone (530-878-0979), fax (530-878-0915) or email: [windmiller-consult@sbcglobal.net](mailto:windmiller-consult@sbcglobal.net). We would appreciate a response at your earliest convenience, if you wish to comment at this time.

Yours sincerely,

Ric Windmiller  
Registered Professional Archaeologist

Enclosure

**Ric Windmiller**  
CONSULTING ARCHAEOLOGIST

2280 GRASS VALLEY HIGHWAY #205  
AUBURN, CALIFORNIA 95603

530/878-0979  
FAX 530/878-0915

August 12, 2011  
Address correction 9/21/2011

Mr. Art Angle  
Vice Chairperson  
Enterprise Rancheria of Maidu Indians  
2133 Monte Vista Avenue  
Oroville, CA 95966-6968

Re: Gray Lodge Water Supply Project, Butte County

Dear Mr. Angle:

Our consultancy is conducting a cultural resources study of approximately 20 miles of existing water canals and canal structures in Butte County. The Gray Lodge Water Supply Project is designed to bring increased water flow to the Gray Lodge Wildlife Area by way of the Biggs-West Gridley Water District's delivery system. The Gray Lodge Wildlife Area is located 65 miles north of Sacramento, California (please see enclosed map).

The Native American Heritage Commission's sacred lands file search failed to identify any Native American cultural resources. A records search by the Northeast Information Center and field inspection by a qualified archaeologist are underway. However, we are aware that a proposed project may affect sites of religious or sacred significance to Native Americans that may not be recognized by non-Native American archaeologists. Therefore, if you have any information or concerns regarding known or suspected sites of Native American significance that may be impacted by the proposed project, please feel free to contact Cathryn Chatterton at the above address. You may also respond by telephone (530-878-0979), fax (530-878-0915) or email: [windmiller-consult@sbcglobal.net](mailto:windmiller-consult@sbcglobal.net). We would appreciate a response at your earliest convenience, if you wish to comment at this time.

Yours sincerely,

Ric Windmiller  
Registered Professional Archaeologist

Enclosure



**Ric Windmiller**  
CONSULTING ARCHAEOLOGIST

2280 GRASS VALLEY HIGHWAY #205  
AUBURN, CALIFORNIA 95603

530/878-0979  
FAX 530/878-0915

August 12, 2011

Ms. Glenda Nelson  
Chairperson  
Enterprise Rancheria of Maidu Indians  
2133 Monta Vista Avenue  
Oroville, CA 95966

Re: Gray Lodge Water Supply Project, Butte County

Dear Ms. Nelson:

Our consultancy is conducting a cultural resources study of approximately 20 miles of existing water canals and canal structures in Butte County. The Gray Lodge Water Supply Project is designed to bring increased water flow to the Gray Lodge Wildlife Area by way of the Biggs-West Gridley Water District's delivery system. The Gray Lodge Wildlife Area is located 65 miles north of Sacramento, California (please see enclosed map).

The Native American Heritage Commission's sacred lands file search failed to identify any Native American cultural resources. A records search by the Northeast Information Center and field inspection by a qualified archaeologist are underway. However, we are aware that a proposed project may affect sites of religious or sacred significance to Native Americans that may not be recognized by non-Native American archaeologists. Therefore, if you have any information or concerns regarding known or suspected sites of Native American significance that may be impacted by the proposed project, please feel free to contact Cathryn Chatterton at the above address. You may also respond by telephone (530-878-0979), fax (530-878-0915) or email: [windmiller-consult@sbcglobal.net](mailto:windmiller-consult@sbcglobal.net). We would appreciate a response at your earliest convenience, if you wish to comment at this time.

Yours sincerely,

Ric Windmiller  
Registered Professional Archaeologist

Enclosure

**Ric Windmiller**  
CONSULTING ARCHAEOLOGIST

2280 GRASS VALLEY HIGHWAY #205  
AUBURN, CALIFORNIA 95603

530/878-0979  
FAX 530/878-0915

August 12, 2011

Mr. Mike DeSpain  
Director -- OEPP  
Mechoopda Indian Tribe of Chico Rancheria  
125 Mission Ranch Blvd.  
Chico, CA 95926

Re: Gray Lodge Water Supply Project, Butte County

Dear Mr. DeSpain:

Our consultancy is conducting a cultural resources study of approximately 20 miles of existing water canals and canal structures in Butte County. The Gray Lodge Water Supply Project is designed to bring increased water flow to the Gray Lodge Wildlife Area by way of the Biggs-West Gridley Water District's delivery system. The Gray Lodge Wildlife Area is located 65 miles north of Sacramento, California (please see enclosed map).

The Native American Heritage Commission's sacred lands file search failed to identify any Native American cultural resources. A records search by the Northeast Information Center and field inspection by a qualified archaeologist are underway. However, we are aware that a proposed project may affect sites of religious or sacred significance to Native Americans that may not be recognized by non-Native American archaeologists. Therefore, if you have any information or concerns regarding known or suspected sites of Native American significance that may be impacted by the proposed project, please feel free to contact Cathryn Chatterton at the above address. You may also respond by telephone (530-878-0979), fax (530-878-0915) or email: [windmiller-consult@sbcglobal.net](mailto:windmiller-consult@sbcglobal.net). We would appreciate a response at your earliest convenience, if you wish to comment at this time.

Yours sincerely,

Ric Windmiller  
Registered Professional Archaeologist

Enclosure

**Ric Windmiller**  
CONSULTING ARCHAEOLOGIST

2280 GRASS VALLEY HIGHWAY #205  
AUBURN, CALIFORNIA 95603

530/878-0979  
FAX 530/878-0915

August 12, 2011

Ms. April Moore  
19630 Placer Hills Road  
Colfax, CA 95713

Re: Gray Lodge Water Supply Project, Butte County

Dear Ms. Moore:

Our consultancy is conducting a cultural resources study of approximately 20 miles of existing water canals and canal structures in Butte County. The Gray Lodge Water Supply Project is designed to bring increased water flow to the Gray Lodge Wildlife Area by way of the Biggs-West Gridley Water District's delivery system. The Gray Lodge Wildlife Area is located 65 miles north of Sacramento, California (please see enclosed map).

The Native American Heritage Commission's sacred lands file search failed to identify any Native American cultural resources. A records search by the Northeast Information Center and field inspection by a qualified archaeologist are underway. However, we are aware that a proposed project may affect sites of religious or sacred significance to Native Americans that may not be recognized by non-Native American archaeologists. Therefore, if you have any information or concerns regarding known or suspected sites of Native American significance that may be impacted by the proposed project, please feel free to contact Cathryn Chatterton at the above address. You may also respond by telephone (530-878-0979), fax (530-878-0915) or email: [windmiller-consult@sbcglobal.net](mailto:windmiller-consult@sbcglobal.net). We would appreciate a response at your earliest convenience, if you wish to comment at this time.

Yours sincerely,

Ric Windmiller  
Registered Professional Archaeologist

Enclosure



OK-11/21 per  
**FAXED** 

**Ric Windmiller**  
CONSULTING ARCHAEOLOGIST

2280 GRASS VALLEY HIGHWAY #205  
AUBURN, CALIFORNIA 95603

530/878-0979  
FAX 530/878-0915

November 18, 2011

Native American Heritage Commission  
915 Capitol Mall, Room 364  
Sacramento, CA 95814

Attn: Ms. Debbie Treadway  
Re: Addendum to Sacred lands file search request for Gray Lodge Water Supply Project

Dear Ms. Treadway:

This letter was prepared on behalf of our client to request a sacred lands file search and the names of appropriate Native American contacts and contact information (address and telephone number). We will use this information in preparing a cultural resources inventory and evaluation report for the Gray Lodge Water Supply Project:

Project ID: Addendum to Gray Lodge Water Supply Project  
USGS 7.5' Quadrangles: Gridley and Pennington  
Legal Description: Butte County:

T. 17N, R. 2E: Sections 4 and 5

Please fax me the response at your earliest convenience.

Ric Windmiller, Consulting Archaeologist, 530-878-0915 (fax).

Yours sincerely,



Ric Windmiller  
Registered Professional Archaeologist

STATE OF CALIFORNIAEdmund G. Brown Jr., Governor**NATIVE AMERICAN HERITAGE COMMISSION**

915 CAPITOL MALL, ROOM 384  
SACRAMENTO, CA 95814  
(916) 853-4082  
Fax (916) 657-5390  
Web Site [www.nahc.ca.gov](http://www.nahc.ca.gov)



November 28, 2011

Ric Windmiller  
Consulting Archaeologist  
2280 Grass Valley Highway #205  
Auburn, CA 95603

Sent by Fax: 530-878-0915

# of Pages: 3

Re: Proposed Addendum to Gray Lodge Water Supply Project, Butte County.

Dear Mr. Windmiller:

A record search of the sacred land file has failed to indicate the presence of Native American cultural resources in the immediate project area. The absence of specific site information in the sacred lands file does not indicate the absence of cultural resources in any project area. Other sources of cultural resources should also be contacted for information regarding known and recorded sites.

Enclosed is a list of Native Americans individuals/organizations who may have knowledge of cultural resources in the project area. The Commission makes no recommendation or preference of a single individual, or group over another. This list should provide a starting place in locating areas of potential adverse impact within the proposed project area. I suggest you contact all of those indicated, if they cannot supply information, they might recommend others with specific knowledge. By contacting all those listed, your organization will be better able to respond to claims of failure to consult with the appropriate tribe or group. If a response has not been received within two weeks of notification, the Commission requests that you follow-up with a telephone call to ensure that the project information has been received.

If you receive notification of change of addresses and phone numbers from any of these individuals or groups, please notify me. With your assistance we are able to assure that our lists contain current information. If you have any questions or need additional information, please contact me at (916) 653-4040.

Sincerely,

Katy Sanchez  
Program Analyst

**Native American Contact List**

Butte County  
November 29, 2011

Berry Creek Rancheria of Maidu Indians  
Cultural Resources Rep  
#5 Tyme Way Tyme Maidu  
Oroville , CA 95966  
gmix@berrycreekrancheria.com  
(530) 534-3859  
(530) 534-1151 FAX

KonKow Valley Band of Maidu  
Patsy Seek, Chairperson  
1706 Sweem Street KonKow / Concow  
Oroville , CA 95965 Maidu  
(530) 533-1504

Mechoopda Indian Tribe of Chico Rancheria  
Dennis E. Ramirez, Chairperson  
125 Mission Ranch Blvd Mechoopda Maidu  
Chico , CA 95926 Concow  
dramirez@mechoopda-nsn.gov  
(530) 899-8922 ext 215  
(530) 899-8517 - Fax

T si-Akim Maidu  
Eileen Moon, Vice Chairperson  
1239 East Main St. Maidu  
Grass Valley , CA 95945  
(530) 477-0711

Butte Tribal Council  
Ren Reynolds  
1693 Mt. Ida Road Maidu  
Oroville , CA 95966  
  
(530) 589-1571

Mooretown Rancheria of Maidu Indians  
James Sanders, Tribal Administrator  
#1 Alverda Drive Maidu  
Oroville , CA 95966 KonKow/Concow  
(530) 533-3625  
(530) 533-3680 FAX

Mooretown Rancheria of Maidu Indians  
Gary Archuleta, Chairperson  
#1 Alverda Drive Maidu  
Oroville , CA 95966 KonKow / Concow  
frontdesk@mooretown.org  
(530) 533-3625  
(530) 533-3680 Fax

Berry Creek Rancheria of Maidu Indians  
Jim Edwards, Chairperson  
#5 Tyme Way Tyme Maidu  
Oroville , CA 95966  
gmix@berrycreekrancheria.com  
(530) 534-3859  
(530) 534-1151 FAX

This list is current only as of the date of this document.

Distribution of this list does not relieve any person of the statutory responsibility as defined in Section 7050.5 of the Health and Safety Code, Section 5097.94 of the Public Resources Code and Section 5097.98 of the Public Resources Code.

This list is only applicable for contacting local Native Americans with regard to cultural resources for the proposed Gray Lodge Water Supply Project; Butte County.



**Native American Contact List**  
Butte County  
November 29, 2011

Enterprise Rancheria of Maidu Indians  
Art Angle, Vice Chairperson  
3690 Olive Hwy Maidu  
Oroville , CA 95966  
eranch@cncnet.com  
(530) 532-9214  
(530) 532-1768 FAX

Enterprise Rancheria of Maidu Indians  
Glenda Nelson, Chairperson  
2133 Monta Vista Ave Maidu  
Oroville , CA 95966  
eranch@cncnet.com  
(530) 532-9214  
(530) 532-1768 FAX

Mechoopda Indian Tribe of Chico Rancheria  
Mike DeSpain, Director - OEPP  
125 Mission Ranch Blvd Mechoopda Maidu  
Chico , CA 95926 Concow  
mdespain@mechoopda-nsn.gov  
(530) 899-8922 ext 219  
(530) 899-8517 - Fax

April Wallace Moore  
19630 Placer Hills Road Nisenan - So Maidu  
Colfax , CA 95713 Konkow  
530-637-4279 Washoe

This list is current only as of the date of this document.

Distribution of this list does not relieve any person of the statutory responsibility as defined in Section 7050.5 of the Health and Safety Code, Section 5097.94 of the Public Resources Code and Section 5097.98 of the Public Resources Code.

This list is only applicable for contacting local Native Americans with regard to cultural resources for the proposed Gray Lodge Water Supply Project; Butte County.

Note: A copy of the map, below, was included with each of the following letters.

GRAY LODGE WATER SUPPLY PROJECT (DASHED LINES)

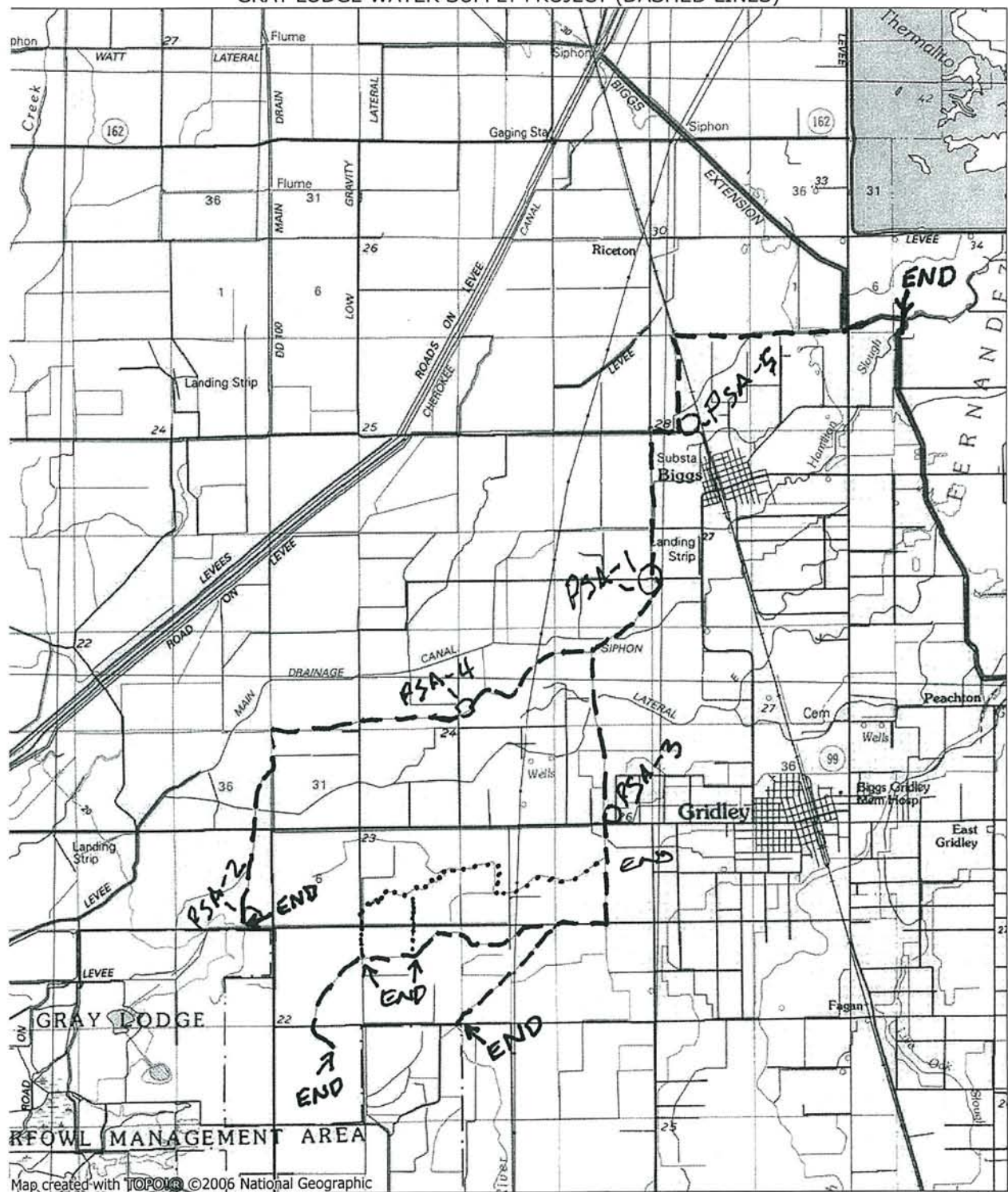
 NATIONAL GEOGRAPHIC

TN\* MN  
14½  
08/12/11

**Ric Windmiller**  
CONSULTING ARCHAEOLOGIST

2280 GRASS VALLEY HIGHWAY #205  
AUBURN, CALIFORNIA 95603

530/878-0979  
FAX 530/878-0915

November 21, 2011

Cultural Resource Representative  
Berry Creek Rancheria of Maidu Indians  
#5 Tyme Way  
Oroville, CA 95966

Re: Gray Lodge Water Supply Project, Butte County

Gentlemen:

On August 12, 2011, I wrote to you about the planned Gray Lodge Water Supply Project, Butte County. In the meantime, the Gerst and Sheppard lateral canals were added to the project design, along with two alternative routes for proposed new canals (see dotted lines on attached map). In addition five proposed staging areas have also been added to the project (PSA-1 through PSA-5 on attached map). As previously noted, the Gray Lodge Water Supply Project is designed to bring increased water flow to the Gray Lodge Wildlife Area by way of the Biggs-West Gridley Water District's delivery system. The Gray Lodge Wildlife Area is located 65 miles north of Sacramento, California.

As we are aware that a proposed project may affect sites of religious or sacred significance to Native Americans that may not be recognized by non-Native American archaeologists, we ask if you have any information or concerns regarding known or suspected sites of Native American significance that may be impacted by the proposed project, please feel free to contact me at the above address. You may also respond by telephone (530-878-0979), fax (530-878-0915) or email: [windmiller-consult@sbcglobal.net](mailto:windmiller-consult@sbcglobal.net). We would appreciate a response at your earliest convenience, if you wish to comment at this time.

Yours sincerely,

Ric Windmiller  
Registered Professional Archaeologist

Enclosure



**From:** Goody Mix (gmix@berrycreekrancheria.com)  
**To:** windmiller-consult@sbcglobal.net;  
**Date:** Thu, December 8, 2011 11:03:19 AM  
**Cc:**  
**Subject:** RE: Gray Lodge Water Supply Project

Ric,  
I know of no known sites. Please keep us informed of your progress.

Goody Mix

---

**From:** Ric Windmiller [mailto:windmiller-consult@sbcglobal.net]  
**Sent:** Thursday, December 08, 2011 10:54 AM  
**To:** Goody Mix  
**Subject:** Gray Lodge Water Supply Project

Dear Cultural Resources Representative:

I am following up on my letter of November 21, 2011 regarding the Gray Lodge Water Supply Project. Briefly, the Biggs- West Gridley Water District in cooperation with the Bureau of Reclamation is planning to upgrade its water delivery system to the Gray Lodge Wildlife Area in south Butte County. I'm contacting you to see if you know of any Native American sacred sites or other sites of Native American importance that may be affected, and if you have any comments or concerns I can note at this time. I am simply gathering information in advance of any consultation that would be conducted by the Bureau of Reclamation.

Please feel free to call or send me an email if you wish to comment at this time.

Yours sincerely,

Ric Windmiller  
Consulting Archaeologist  
2280 Grass Valley Hwy. #205  
Auburn, CA 95603  
(530) 878-0979 (office)  
(530) 878-0915 (fax)  
(916) 716-4561 (mobile)  
[windmiller-consult@sbcglobal.net](mailto:windmiller-consult@sbcglobal.net)

**Ric Windmiller**  
CONSULTING ARCHAEOLOGIST

2280 GRASS VALLEY HIGHWAY #205  
AUBURN, CALIFORNIA 95603

530/878-0979  
FAX 530/878-0915

November 21, 2011

Mr. Dennis E. Ramirez  
Chairperson  
Mechoopda Indian Tribe of Chico Rancheria  
125 Mission Ranch Blvd.  
Chico, CA 95926

Re: Gray Lodge Water Supply Project, Butte County

Dear Mr. Ramirez:

On August 12, 2011, I wrote to you about the planned Gray Lodge Water Supply Project, Butte County. In the meantime, the Gerst and Sheppard lateral canals were added to the project design, along with two alternative routes for proposed new canals (see dotted lines on attached map). In addition five proposed staging areas have also been added to the project (PSA-1 through PSA-5 on attached map). As previously noted, the Gray Lodge Water Supply Project is designed to bring increased water flow to the Gray Lodge Wildlife Area by way of the Biggs-West Gridley Water District's delivery system. The Gray Lodge Wildlife Area is located 65 miles north of Sacramento, California.

As we are aware that a proposed project may affect sites of religious or sacred significance to Native Americans that may not be recognized by non-Native American archaeologists, we ask if you have any information or concerns regarding known or suspected sites of Native American significance that may be impacted by the proposed project, please feel free to contact me at the above address. You may also respond by telephone (530-878-0979), fax (530-878-0915) or email: [windmiller-consult@sbcglobal.net](mailto:windmiller-consult@sbcglobal.net). We would appreciate a response at your earliest convenience, if you wish to comment at this time.

Yours sincerely,

Ric Windmiller  
Registered Professional Archaeologist

Enclosure

**Ric Windmiller**  
CONSULTING ARCHAEOLOGIST

2280 GRASS VALLEY HIGHWAY #205  
AUBURN, CALIFORNIA 95603

530/878-0979  
FAX 530/878-0915

November 21, 2011

Mr. Kyle Self  
Chairperson  
Greenville Rancheria of Maidu Indians  
P. Box Box 279  
Greenville, CA 95947

Re: Gray Lodge Water Supply Project, Butte County

Dear Mr. Self:

On August 12, 2011, I wrote to you about the planned Gray Lodge Water Supply Project, Butte County. In the meantime, the Gerst and Sheppard lateral canals were added to the project design, along with two alternative routes for proposed new canals (see dotted lines on attached map). In addition five proposed staging areas have also been added to the project (PSA-1 through PSA-5 on attached map). As previously noted, the Gray Lodge Water Supply Project is designed to bring increased water flow to the Gray Lodge Wildlife Area by way of the Biggs-West Gridley Water District's delivery system. The Gray Lodge Wildlife Area is located 65 miles north of Sacramento, California.

As we are aware that a proposed project may affect sites of religious or sacred significance to Native Americans that may not be recognized by non-Native American archaeologists, we ask if you have any information or concerns regarding known or suspected sites of Native American significance that may be impacted by the proposed project, please feel free to contact me at the above address. You may also respond by telephone (530-878-0979), fax (530-878-0915) or email: [windmiller-consult@sbcglobal.net](mailto:windmiller-consult@sbcglobal.net). We would appreciate a response at your earliest convenience, if you wish to comment at this time.

Yours sincerely,

Ric Windmiller  
Registered Professional Archaeologist

Enclosure



**Ric Windmiller**  
CONSULTING ARCHAEOLOGIST

2280 GRASS VALLEY HIGHWAY #205  
AUBURN, CALIFORNIA 95603

530/878-0979  
FAX 530/878-0915

November 21, 2011

Ms. Clara LeCompte  
Maidu Nation  
P.O. Box 204  
Susanville, CA 96130

Re: Gray Lodge Water Supply Project, Butte County

Dear Ms. LeCompte:

On August 12, 2011, I wrote to you about the planned Gray Lodge Water Supply Project, Butte County. In the meantime, the Gerst and Sheppard lateral canals were added to the project design, along with two alternative routes for proposed new canals (see dotted lines on attached map). In addition five proposed staging areas have also been added to the project (PSA-1 through PSA-5 on attached map). As previously noted, the Gray Lodge Water Supply Project is designed to bring increased water flow to the Gray Lodge Wildlife Area by way of the Biggs-West Gridley Water District's delivery system. The Gray Lodge Wildlife Area is located 65 miles north of Sacramento, California.

As we are aware that a proposed project may affect sites of religious or sacred significance to Native Americans that may not be recognized by non-Native American archaeologists, we ask if you have any information or concerns regarding known or suspected sites of Native American significance that may be impacted by the proposed project, please feel free to contact me at the above address. You may also respond by telephone (530-878-0979), fax (530-878-0915) or email: [windmiller-consult@sbcglobal.net](mailto:windmiller-consult@sbcglobal.net). We would appreciate a response at your earliest convenience, if you wish to comment at this time.

Yours sincerely,

Ric Windmiller  
Registered Professional Archaeologist

Enclosure

**Ric Windmiller**  
CONSULTING ARCHAEOLOGIST

2280 GRASS VALLEY HIGHWAY #205  
AUBURN, CALIFORNIA 95603

530/878-0979  
FAX 530/878-0915

November 21, 2011

Mr. Ren Reynolds  
Butte Tribal Council  
1693 Mt. Ida Road  
Oroville, CA 95966

Re: Gray Lodge Water Supply Project, Butte County

Dear Mr. Reynolds:

On August 12, 2011, I wrote to you about the planned Gray Lodge Water Supply Project, Butte County. In the meantime, the Gerst and Sheppard lateral canals were added to the project design, along with two alternative routes for proposed new canals (see dotted lines on attached map). In addition five proposed staging areas have also been added to the project (PSA-1 through PSA-5 on attached map). As previously noted, the Gray Lodge Water Supply Project is designed to bring increased water flow to the Gray Lodge Wildlife Area by way of the Biggs-West Gridley Water District's delivery system. The Gray Lodge Wildlife Area is located 65 miles north of Sacramento, California.

As we are aware that a proposed project may affect sites of religious or sacred significance to Native Americans that may not be recognized by non-Native American archaeologists, we ask if you have any information or concerns regarding known or suspected sites of Native American significance that may be impacted by the proposed project, please feel free to contact me at the above address. You may also respond by telephone (530-878-0979), fax (530-878-0915) or email: [windmiller-consult@sbcglobal.net](mailto:windmiller-consult@sbcglobal.net). We would appreciate a response at your earliest convenience, if you wish to comment at this time.

Yours sincerely,

Ric Windmiller  
Registered Professional Archaeologist

Enclosure

**Ric Windmiller**  
CONSULTING ARCHAEOLOGIST

2280 GRASS VALLEY HIGHWAY #205  
AUBURN, CALIFORNIA 95603

530/878-0979  
FAX 530/878-0915

November 21, 2011

Mr. Gary Archuleta  
Chairperson  
Mooretown Rancheria of Maidu Indians  
#1 Alverda Drive  
Oroville, CA 95966

Re: Gray Lodge Water Supply Project, Butte County

Dear Mr. Archuleta:

On August 12, 2011, I wrote to you about the planned Gray Lodge Water Supply Project, Butte County. In the meantime, the Gerst and Sheppard lateral canals were added to the project design, along with two alternative routes for proposed new canals (see dotted lines on attached map). In addition five proposed staging areas have also been added to the project (PSA-1 through PSA-5 on attached map). As previously noted, the Gray Lodge Water Supply Project is designed to bring increased water flow to the Gray Lodge Wildlife Area by way of the Biggs-West Gridley Water District's delivery system. The Gray Lodge Wildlife Area is located 65 miles north of Sacramento, California.

As we are aware that a proposed project may affect sites of religious or sacred significance to Native Americans that may not be recognized by non-Native American archaeologists, we ask if you have any information or concerns regarding known or suspected sites of Native American significance that may be impacted by the proposed project, please feel free to contact me at the above address. You may also respond by telephone (530-878-0979), fax (530-878-0915) or email: [windmiller-consult@sbcglobal.net](mailto:windmiller-consult@sbcglobal.net). We would appreciate a response at your earliest convenience, if you wish to comment at this time.

Yours sincerely,

Ric Windmiller  
Registered Professional Archaeologist

Enclosure



**Ric Windmiller**  
CONSULTING ARCHAEOLOGIST

2280 GRASS VALLEY HIGHWAY #205  
AUBURN, CALIFORNIA 95603

530/878-0979  
FAX 530/878-0915

November 21, 2011

Ms. Lorena Gorbet  
Maidu Cultural and Development Group  
P.O. Box 426  
Greenville, CA 95947

Re: Gray Lodge Water Supply Project, Butte County

Dear Ms. Gorbet:

On August 12, 2011, I wrote to you about the planned Gray Lodge Water Supply Project, Butte County. In the meantime, the Gerst and Sheppard lateral canals were added to the project design, along with two alternative routes for proposed new canals (see dotted lines on attached map). In addition five proposed staging areas have also been added to the project (PSA-1 through PSA-5 on attached map). As previously noted, the Gray Lodge Water Supply Project is designed to bring increased water flow to the Gray Lodge Wildlife Area by way of the Biggs-West Gridley Water District's delivery system. The Gray Lodge Wildlife Area is located 65 miles north of Sacramento, California.

As we are aware that a proposed project may affect sites of religious or sacred significance to Native Americans that may not be recognized by non-Native American archaeologists, we ask if you have any information or concerns regarding known or suspected sites of Native American significance that may be impacted by the proposed project, please feel free to contact me at the above address. You may also respond by telephone (530-878-0979), fax (530-878-0915) or email: [windmiller-consult@sbcglobal.net](mailto:windmiller-consult@sbcglobal.net). We would appreciate a response at your earliest convenience, if you wish to comment at this time.

Yours sincerely,

Ric Windmiller  
Registered Professional Archaeologist

Enclosure